



**Massachusetts Bay  
Transportation Authority**

# Worcester Union Station Accessibility and Infrastructure Improvements

---

Stakeholder Meeting

March 10, 2020

Worcester Chamber of Commerce

Maribel Kelly, Sr. Project Manager

# Agenda

---

- Team Introduction
- Project Goals
- Project Overview
  - Purpose and Need
  - Project Benefits
  - Existing Station Layout
  - Proposed Station Layout
- Environmental Considerations
- Project Schedule
- Construction Phasing
- Q&A



# Team Introduction

---

## **MBTA**

Nazanin Mossahebi, Deputy AGM, Capital Delivery Commuter Rail Programs  
Anthony DeDominicis, Sr. Director of Commuter Rail  
Maribel Kelly, Sr. Project Manager

## **HDR (Design Consultant)**

Anthony Gouveia, Principal in Charge  
Eric DiVirgilio, Project Manager  
Salina Martin, Project Engineer  
Michael Baskin, Architect



# Project Goals

---

- Accessibility
- Safety
- Operational Flexibility
- Sustainability
- Resiliency



# Project Overview – Purpose and Needs

---

- A safe and secure station: improved lighting, clear site lines, security cameras, fencing along the station track, etc.
- Increase reliability and operational flexibility with a center island high level platform to allow two train sets simultaneous access to the platform and the addition of a crossover to allow parallel moves at the interlocking.
- Infrastructure upgrades to improve the frequency, convenience and reliability of passenger rail services and safety.
- Implement accessibility improvements to comply with Americans with Disabilities Act (ADA), Massachusetts Architectural Access Board (MAAB), and System-Wide Accessibility (SWA) requirements.



# Project Overview– Project Benefits

---

- Increase passenger and overall **system safety**.
- Implement **ADA upgrades** to fulfill code compliance requirements.
- Improve **reliability** and **resilience**.
- Increase **capacity** and **operational reliability, flexibility** and **resiliency** for both MBTA and Amtrak services in the near and long-terms.
- **Reduce** station life cycle maintenance costs and **lower** energy consumption.



# Project Overview – Project Station Layout

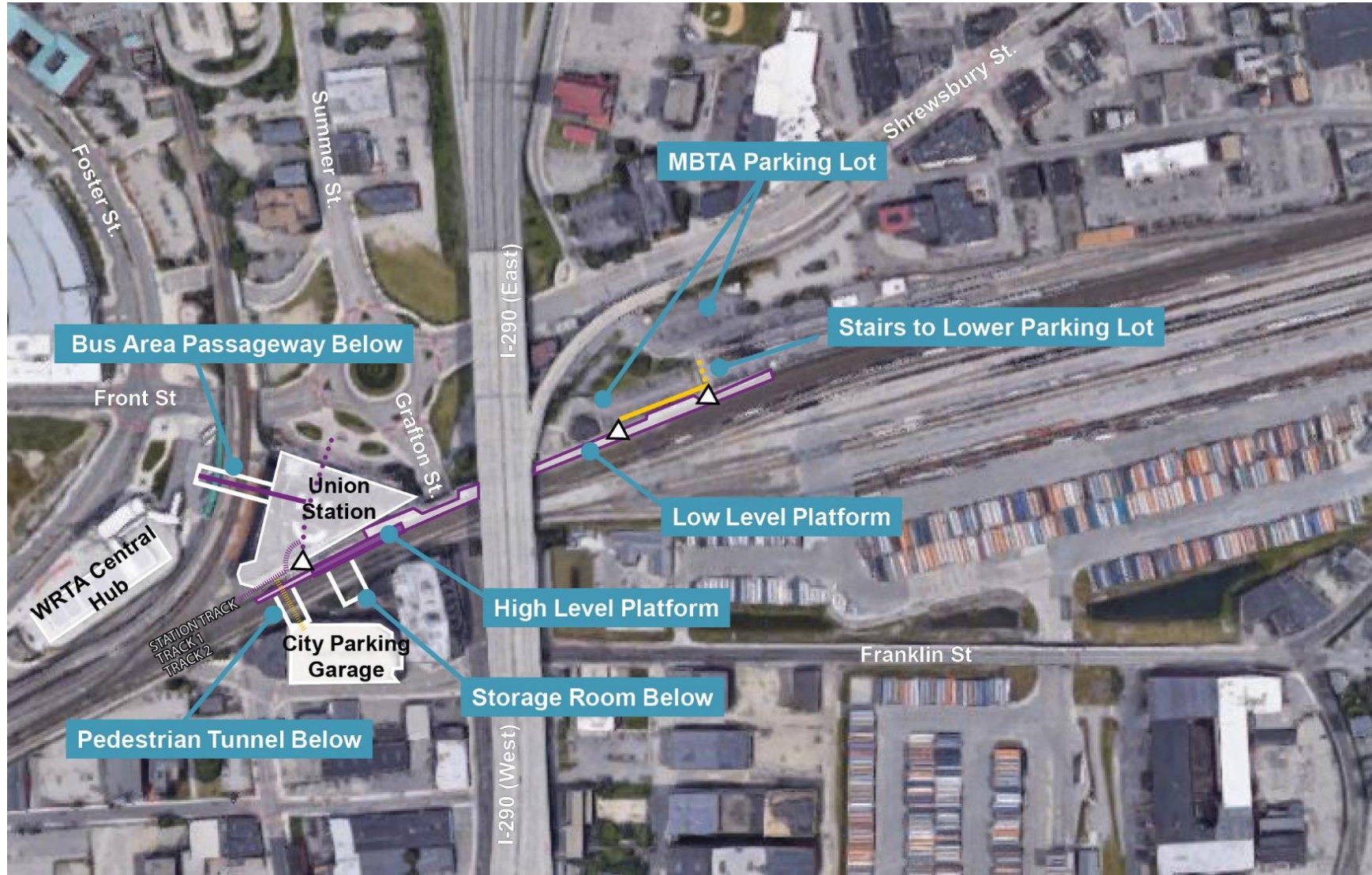

# Project Overview – Overall 3D View at Station

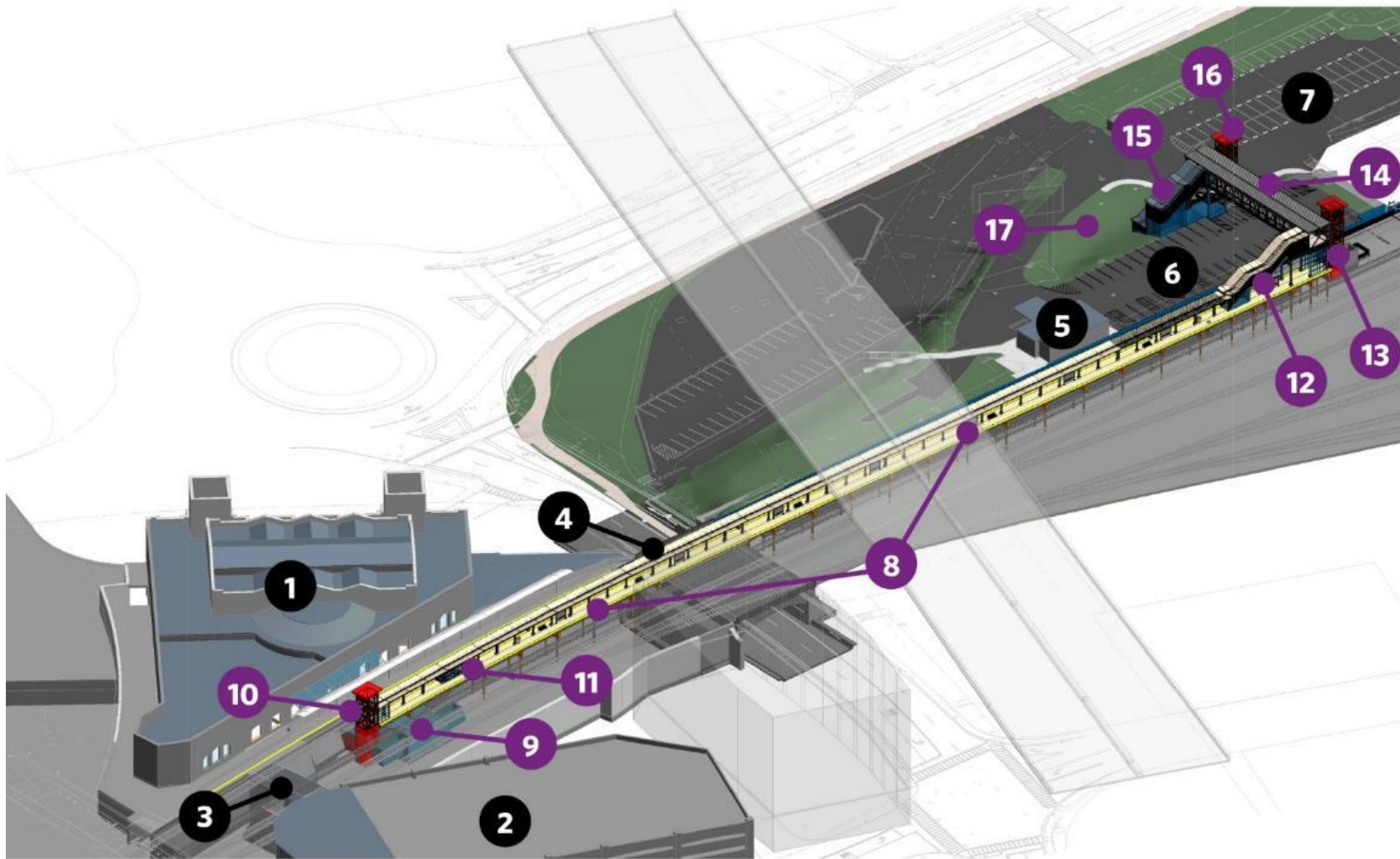

## EXISTING FEATURES:

1. Union Station Building
2. Union Station Parking Garage
3. Pedestrian Tunnel to Parking Garage
4. Grafton St. Bridge
5. Keolis Building
6. MBTA Upper Parking Lot
7. MBTA Lower Parking Lot

## PROPOSED FEATURES:

8. Center Island Platform
9. Platform Access Corridor (Below)
10. Elevator #1
11. Stair #1
12. Stair #2
13. Elevator #2
14. Pedestrian Bridge
15. Stair #3
16. Elevator #3
17. Rainwater Retention Area



# Project Overview – West End 3D View

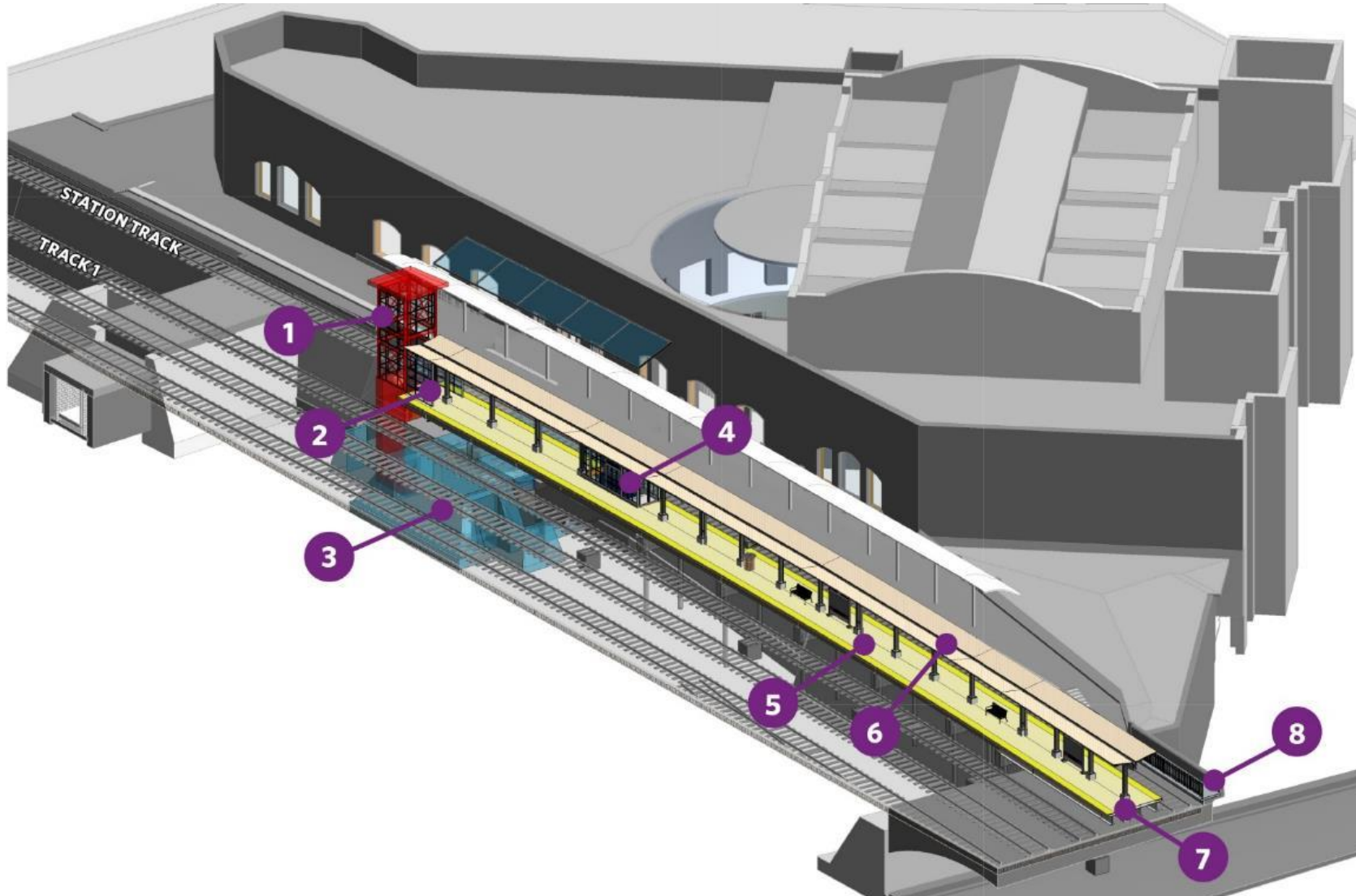

## KEY FEATURES:

1. Elevator #1
2. Elevator Lobby at Platform
3. Platform Access Corridor (Below)
4. Stair #1 w/ Enclosure
5. Center Island Platform
6. Continuous Canopy
7. Platform Spans Over Grafton St. Bridge
8. Accessible Walkway



# Project Overview – Rendering from Garage Roof



# Project Overview – Rendering at West End from Platform

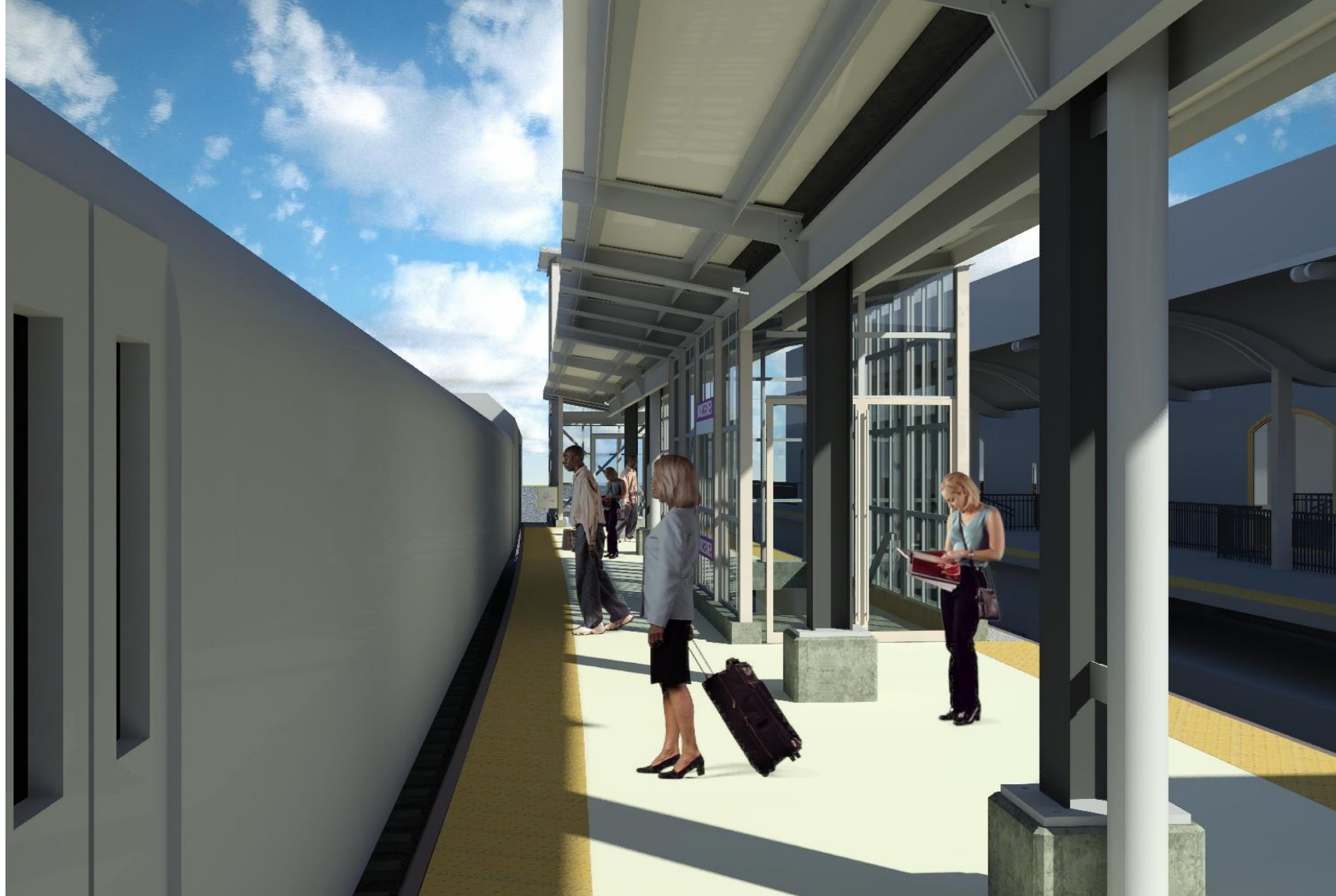

# Project Overview – East End 3D View

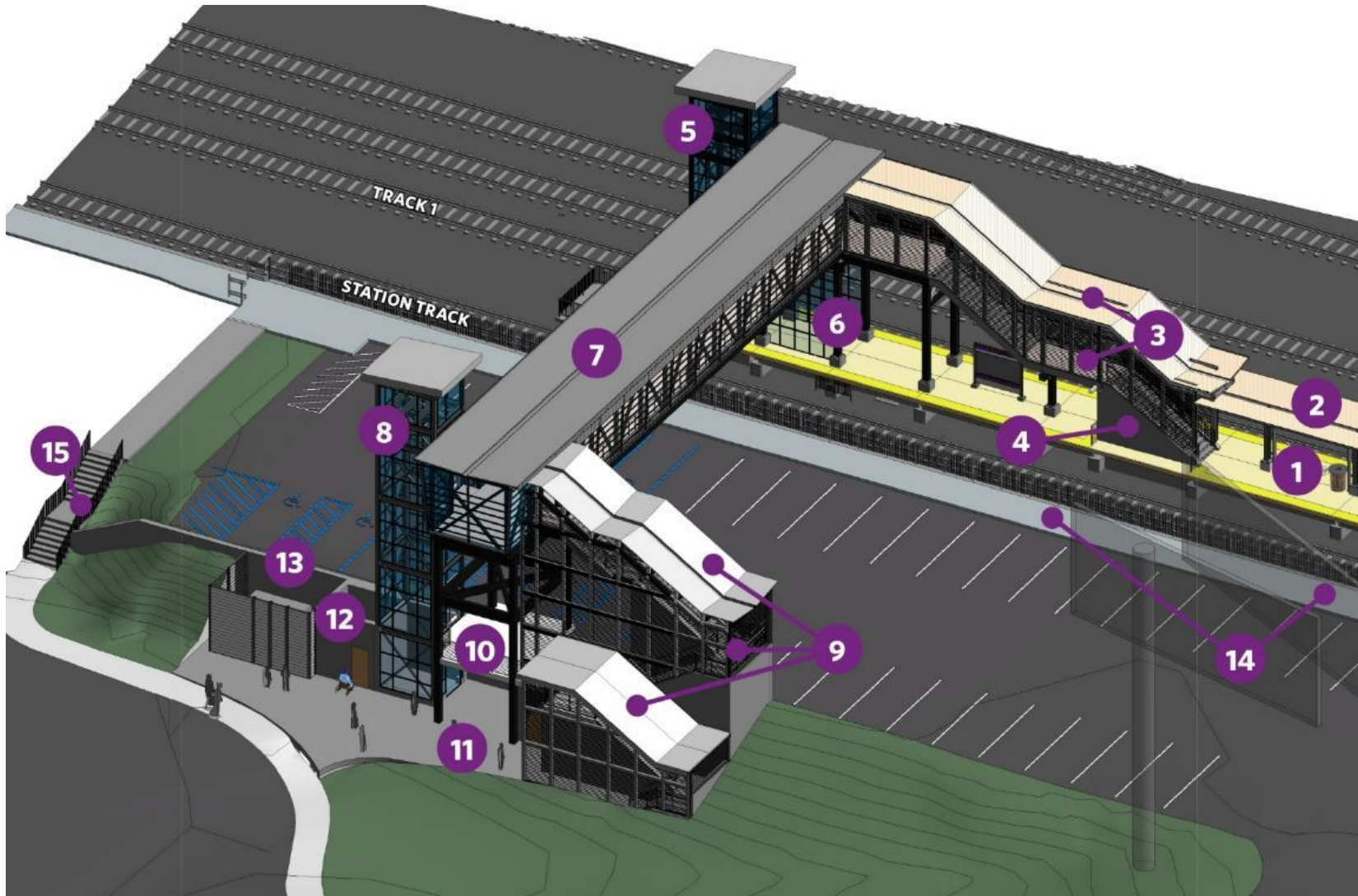

## KEY FEATURES:

1. Center Island Platform
2. Continuous Canopy
3. Stair #2 w/ Roof & Screening
4. Storage Room Below Stairs
5. Elevator #2
6. Elevator Lobby
7. Pedestrian Bridge
8. Elevator #3
9. Stair #3 w/ Roof & Screening
10. Upper Landing
11. Lower Landing / Plaza
12. EMR #3
13. Backup Generator & Enclosure
14. Accessible Walkway w/ Fence
15. Existing Concrete Stair

# Project Overview– Rendering at East End from Platform



# Project Overview - Rendering from Upper Parking Lot



# Project Overview – Rendering from Lower Parking Lot



# Project Overview – Platform Access from Union Station

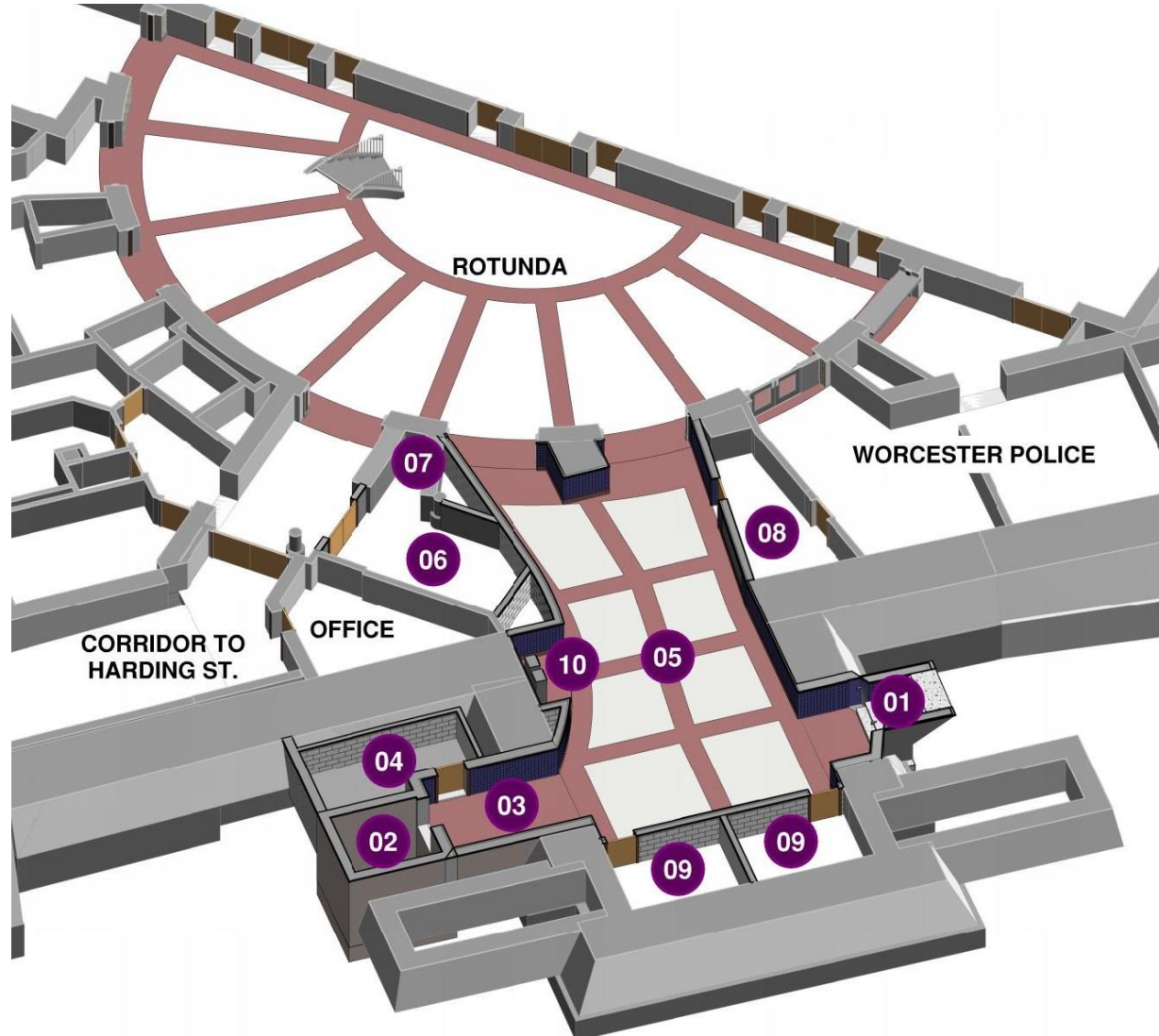

## KEY FEATURES:

1. Stair #1
2. Elevator #1
3. Elevator Lobby
4. Elevator #1 Machine Rm.
5. Platform Access Corridor
6. Mechanical Rm.
7. Exist. 3<sup>rd</sup> Party Comm. Equipment
8. Police Access Vestibule
9. MBTA Offices
10. Ticketing Alcove





# Project Overview – Rendering from Rotunda



# Project Overview – Rendering from Platform Access Corridor



# Environmental Conditions

---

- Environmental conditions:
  - No adverse effect on historic properties
  - Ongoing Coordination with FTA, Worcester Historical Commission and Massachusetts Historic Commission (MHC)
  - Soil management requirements evaluated; routine for railroad ROW soils
- Environmental improvements:
  - Storm water treatment and management improvements.
  - LED lighting to minimize energy consumption.



# Project Schedule

MILESTONE	SCHEDULE
30% Submission	07/2019
75% Submission	11/2019
100% PS&E	06/2020
Bid Phase	08/2020 - 10/2020*
NTP Construction	11/2020
Project Completed	11/2022

\* Pending Construction Funding



# Construction Phasing

---

## CONSTRUCTION PHASING



# Construction Phasing – Phase 1 (Approx. Duration: 3 Months)

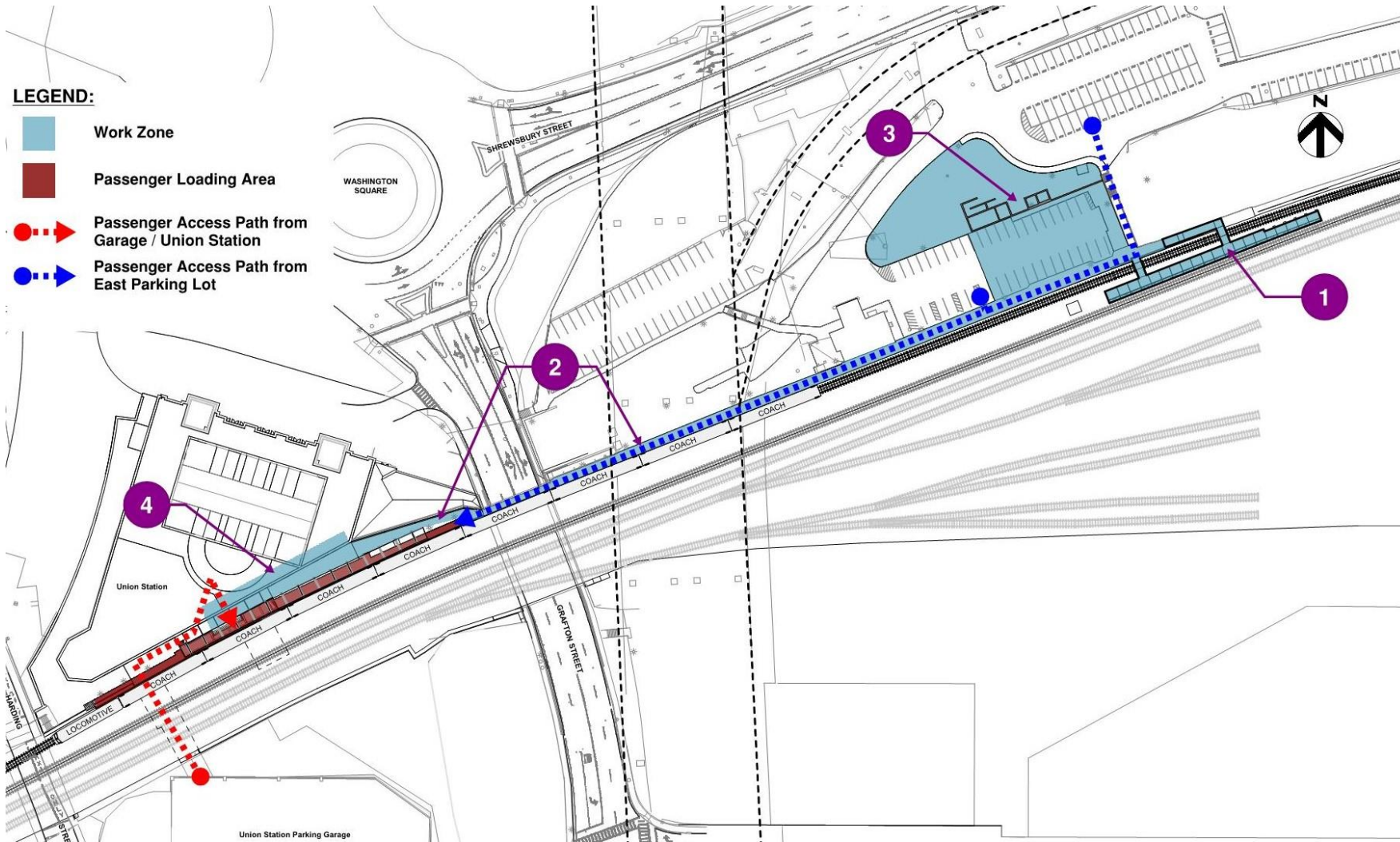

## Passenger Access:

- No change to passenger access.
- Existing high-level platform remains in service

## Construction Activities:

1. Construct temporary platform, ramp, and stairs east of proposed platform.
2. Convert existing low level platform into code compliant accessible walkway and install fence.
3. Begin work for new Retaining Wall, Electrical and Comm. Rooms at East Parking Lot.
4. Begin demolition inside Union Station.

# Construction Phasing – Phase 2 (Approx. Duration: 12 Months)

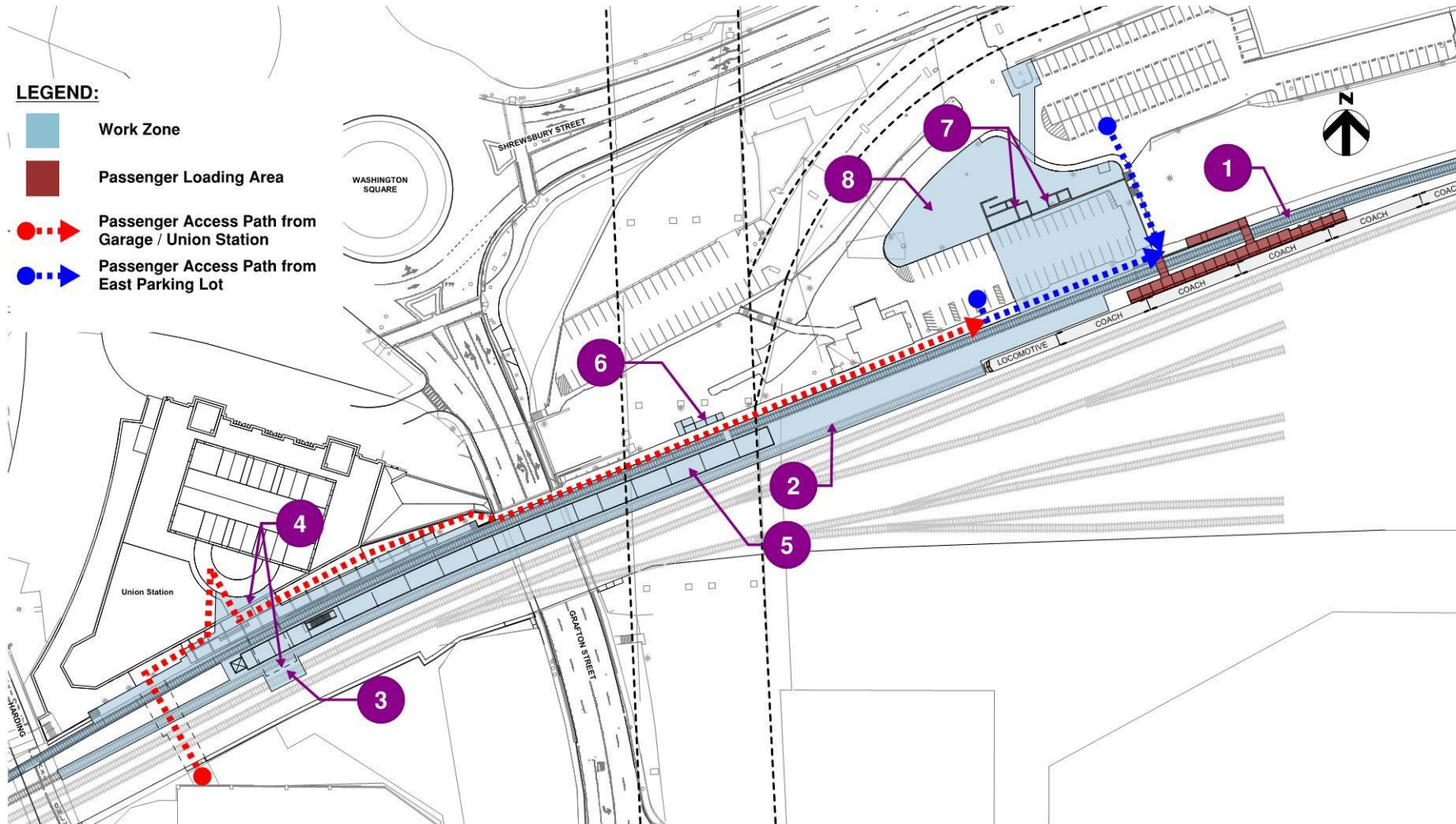

## Passenger Access:

- Passenger loading is relocated to the temporary platform.
- The temporary platform will be accessed from the accessible walkway via stairs and a ramp.
- All trains will board from Track 1, with access to the 1st 4 cars.

## Construction Activities:

1. Station Track is taken out of service to adjust profile.
2. Replace Track 1 in segments during non-revenue hours.
3. Portion of Track 2 is taken out of service to apply waterproofing.
4. Continue work within the station building.
5. Install micro piles and construct the west side of the platform.
6. Construct temporary ramp at the east end of the newly constructed portion of the platform.
7. Complete the electrical and comms. rooms at the east end.
8. Complete parking plaza and greenway area.

# Construction Phasing – Phase 3 (Approx. Duration: 9 Months)

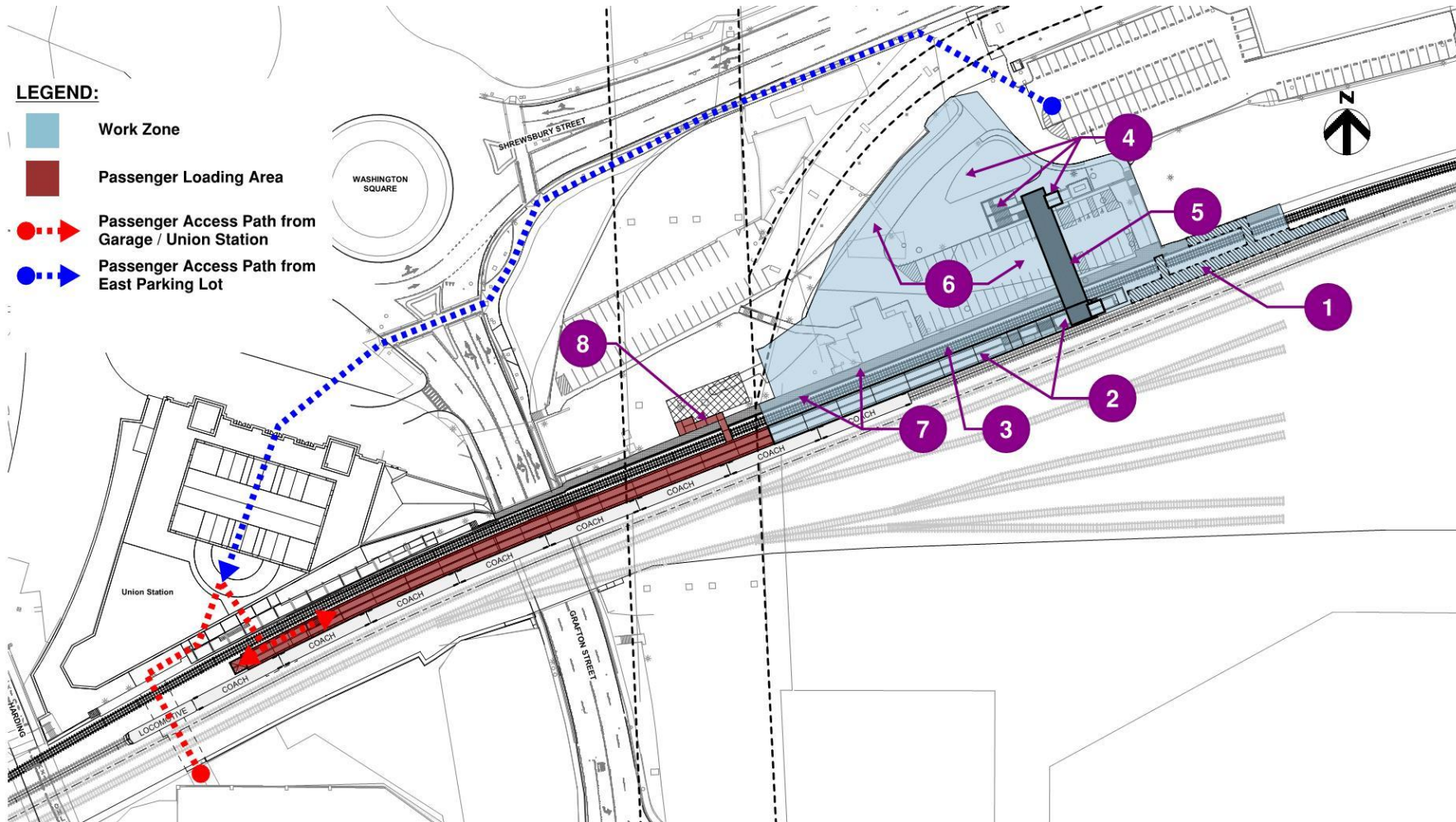

## Passenger Access:

- Passenger loading is relocated to the west half of the new platform.
- The west half of the new platform will be accessed through the Union Station Building.
- All trains will board from Track 1, with access to up to 6 cars.
- All accessible parking is relocated to the parking garage.

## Construction Activities:

1. Demolish temporary platform, ramp, and stairs.
2. Construct the east end of the platform.
3. Replace eastern section of Station Track.
4. Construct the North Stairs and Elevator.
5. Construct the pedestrian bridge.
6. Resurface and stripe exist. parking lots & driveway.
7. Provide permanent accessible walkway and fencing.
8. Secondary egress from west half of platform via ramp & area of rescue assistance.



# Public Outreach

---

## Project Website

<https://www.mbta.com/UnionStation>

Public and Stakeholders can sign up for email updates from project on website.

## Project Email

[UnionStation@mbta.com](mailto:UnionStation@mbta.com)



THANK YOU

---

# Questions & Answers

