



# **C Branch Track & Intersection Upgrades**

---

## ***Virtual Public Meeting***

June 29, 2020



# SAFETY MOMENT

*Wear a face covering when riding public transit*

*Stay Healthy & Be Safe*



# Welcome

## Agenda

- **Green Line Transformation**
- **C Branch Track & Intersection Upgrades**
- **Making Connections During Construction**
- **Construction Sequence**
- **Stay Connected**





---

## Green Line Transformation



## Our Goal



Improve the Green Line **quality of service**, including **increased capacity** and **enhanced accessibility**, through fleet modernization, infrastructure/facility upgrades and **state-of-the-art technology**

# Quality of Service | *Providing Service that Riders Expect and Deserve*

Green Line improvements target five key service metrics focused on our riders



## **Safety**

*Mitigate service interruptions due to safety concerns*



## **Capacity**

*Increase speed, frequency, and capacity*



## **Reliability**

*Improve reliability and regularity of service*



## **Access**

*Improve passenger circulation and ADA compliance*



## **Experience**

*Improve comfort, convenience and communication*



# Ride Safer | *We're committed to public health on public transportation*



For the **safety of our riders, employees and contractors** during the public health crisis, additional measures are in place, with up to date information at [mbta.com/covid19/ride-safer](https://www.mbta.com/covid19/ride-safer)

## Stations

- Cleaning of high-contact surfaces **every 4 hours**
- In-station **hand sanitizer** dispensers more widely dispersed

## Vehicles

- Buses will be disinfected **every 24 hours**
- Seats directly behind the vehicle operator unavailable to maintain distance
- Seated passengers only to maintain **social distancing**

## Operators

- Operator's temperature to be checked pre-shift for elevated temperatures
- We strongly encourage everyone to wear **face coverings** during this time

## Contractors

- Job briefings and breaks will be staggered / in small groups
- All personnel will use **personal protective equipment**

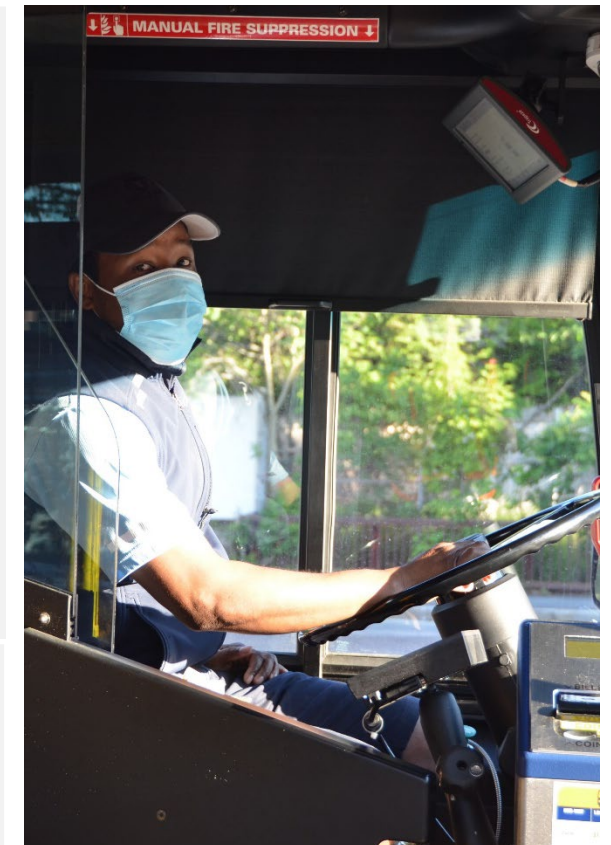

# Green Line Full Track Renewal Plan

## Acceleration 2019 (Completed)

1.6 miles (4%) - 8,480 feet (completed)

- B & C Branches (Green Line Intersection Upgrades)

## Adequate Track

16.7 miles (36%) - 88,120 feet

- D Branch 2019: 10,000 feet

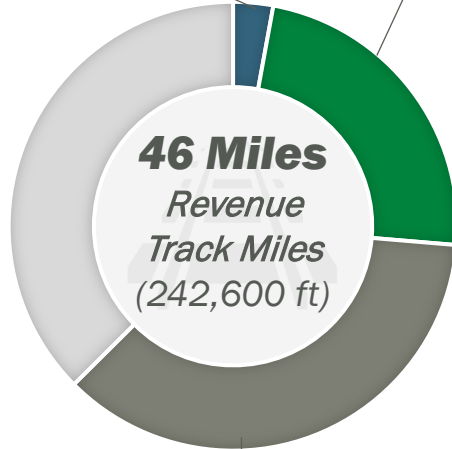

## Remaining Work - Design Underway

16.7 miles (88,000 feet) (36%) 2021 - 2024

- B Branch, Packards to Warren + Blandford (15,000 ft)
- Central Tunnel - to all portals (50,000 ft)
- D Branch - Beaconsfield to Fenway (19,000 ft)
- Brigham - Mission Park (4,000 ft)

## 2020 Safety Investment & Capital Acceleration Plan

11 miles (24%) - 58,000 feet

- 33,000 feet B, C, E
- 17,000 feet through D Branch Track & Signal (10,000 completed in 2019)
- 8,000 Lechmere Viaduct (track finished in 2020)
- Reduces average GL track age by ~10 years



This work is part of the vision for the Green Line Transformation (GLT) program

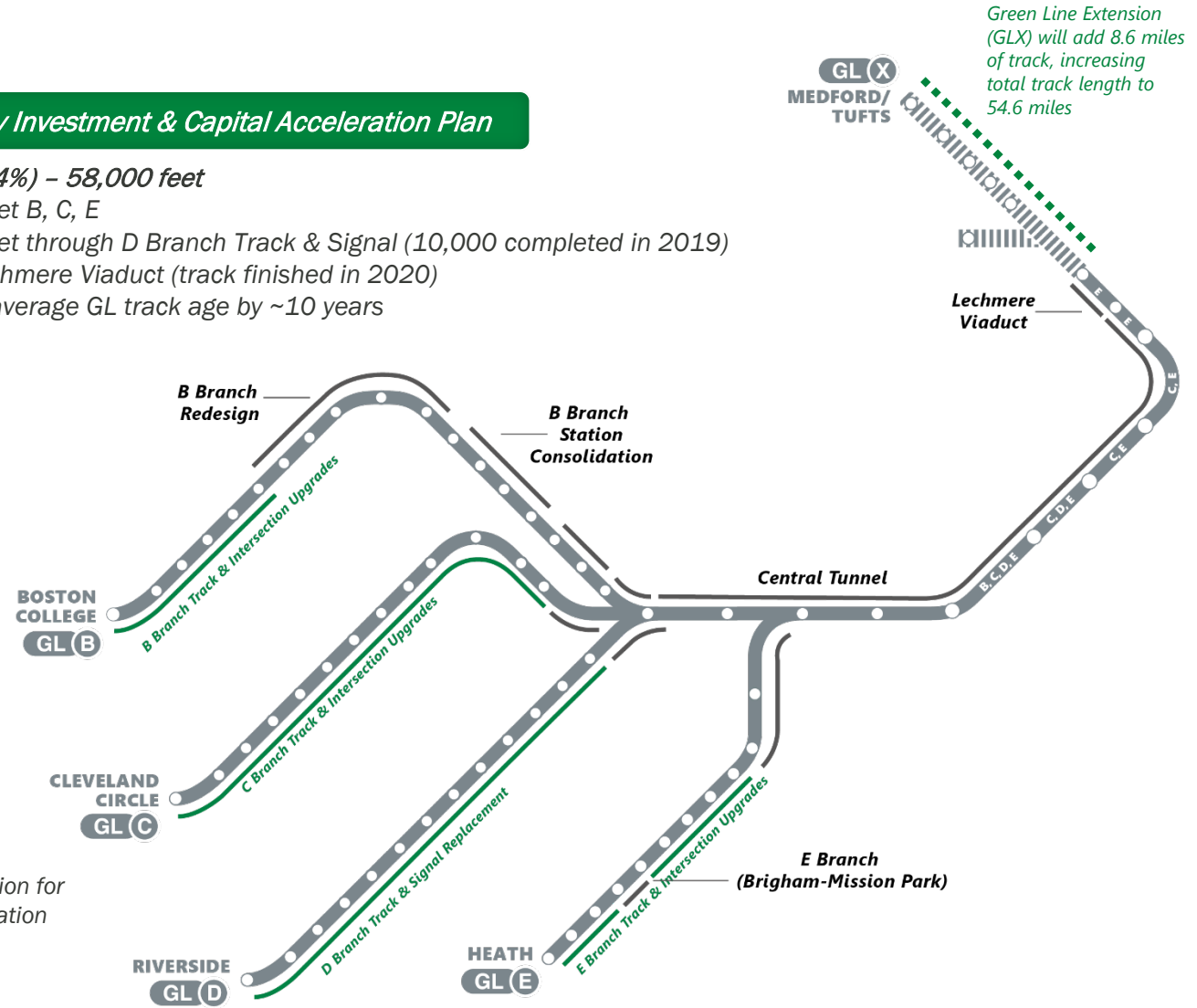



# Project Details | Green Line Projects in 2020

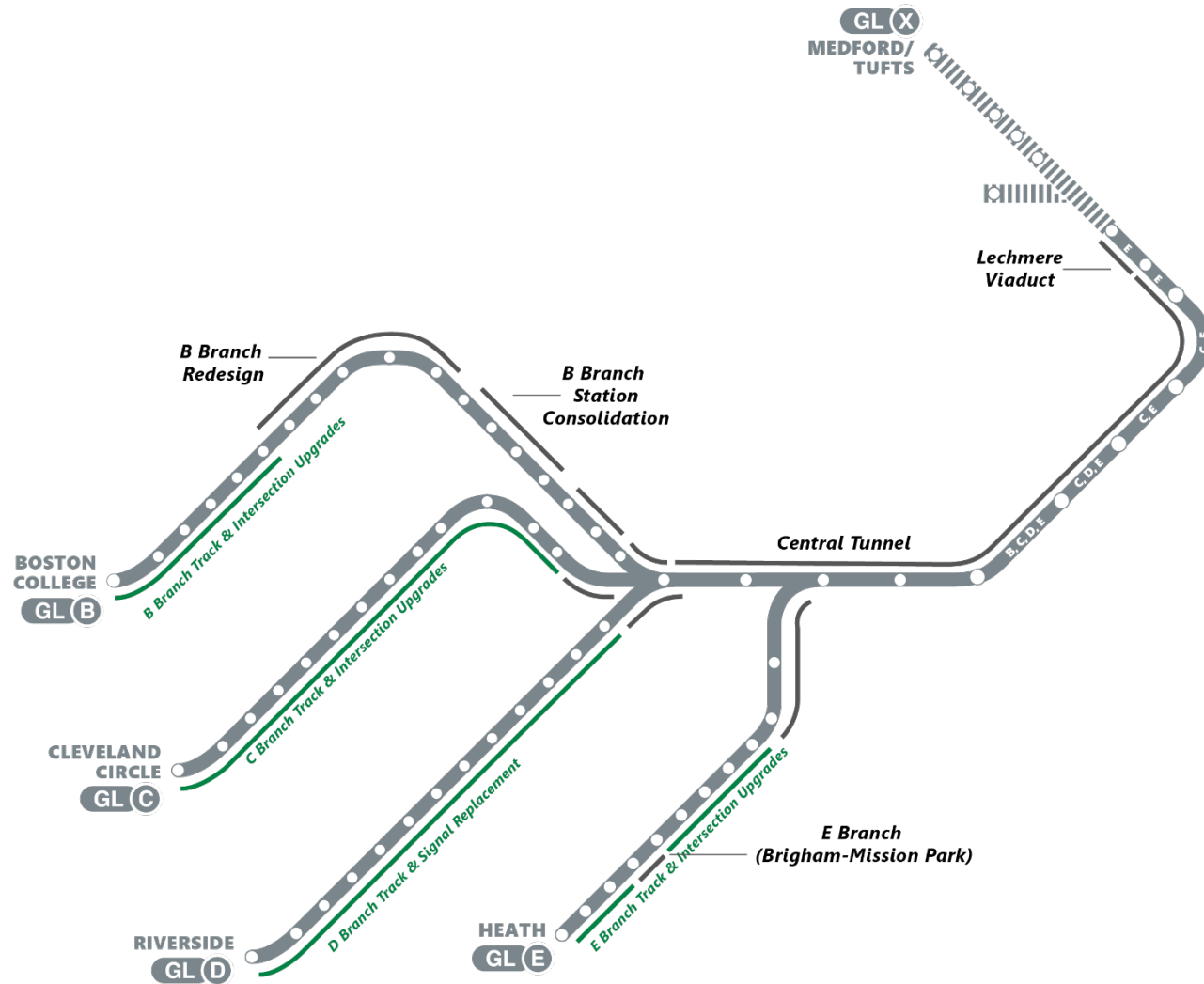

GREEN LINE PROJECTS	LOCATION
<b>B BRANCH</b>	
B Branch Station Consolidation	Babcock St – BU West
B Branch Track & Intersection Upgrades	Boston College – Blandford
<b>C BRANCH</b>	
C Branch Track & Intersection Upgrades	Cleveland Circle – Kenmore
Green Line Transit Signal Priority (TSP)*	Cleveland Circle – Kenmore
Beacon Junction Special Trackwork*	St Marys – Kenmore
Duct Bank Work*	Washington Square
<b>D BRANCH</b>	
D Branch Track & Signal Replacement	Riverside – Beaconsfield
Fenway Portal Flood Protection	Kenmore – Fenway
Brookline High School Expansion Project (TOD)*	Brookline Hills Station
<b>E BRANCH</b>	
Lechmere Viaduct Rehabilitation	Lechmere – North Station
E Branch Track & Intersection Upgrades	Heath – Symphony
Green Line Extension*	Somerville/Medford

\*Concurrent projects underway by other Departments

# Construction Strategy | Condensed Duration Delivers Results Sooner

A **28-day closure** replaces **1 year** of delays, slow zones, and early access/weekend diversions — *reducing inconvenience to riders*—to improve **safety and reliability sooner**

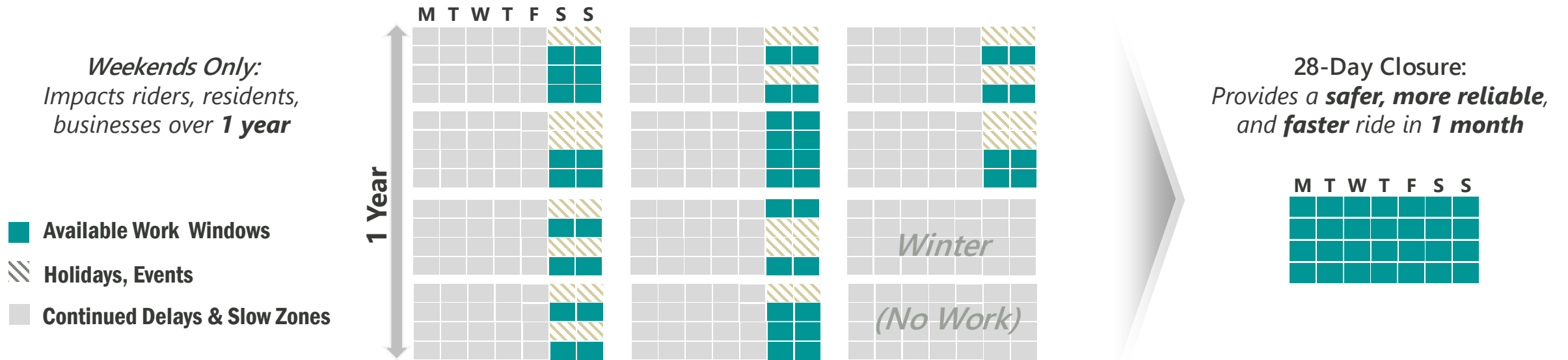

**1 Year, Non-Stop Night Work (Work Scope Limited)**

**20 Weeks of Early Access (Mon–Fri) (Work Scope Limited)**

**18 - 20 Weekend Diversions spread over 1 year**

=

**4 Weeks (28-Days)**

A 28-Day closure is more **efficient than year** of diversions or night work **1**



---

## **C Branch Track & Intersection Upgrades**



# Green Line C Branch At-a-Glance | Cleveland Circle to Kenmore



**~32,000**  
Track Feet  
(5.9 miles)



**33 Years**  
Average Age of  
Track (1986)



**18 Intersections**  
Road  
Crossings



**13 Stations**  
Surface  
Level



**~12,000**  
Weekday  
Riders (2014)



APRIL	MAY	JUNE	JULY	AUG	SEPT	OCT	NOV	DEC
			<b>C</b> July 5-Aug 1	<b>Cleveland Circle - Kenmore</b> 🚃 <i>C Branch Track &amp; Intersection Upgrades</i>				

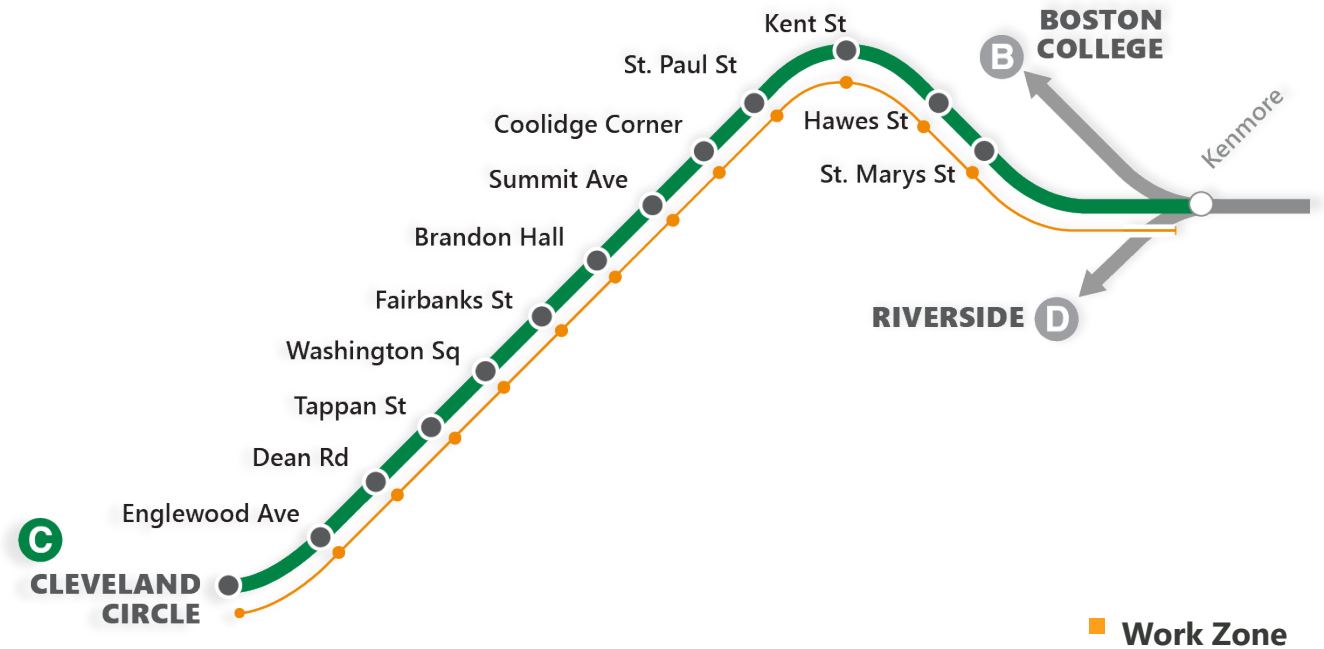

# Track & Intersection Upgrades | *Scope of Work*

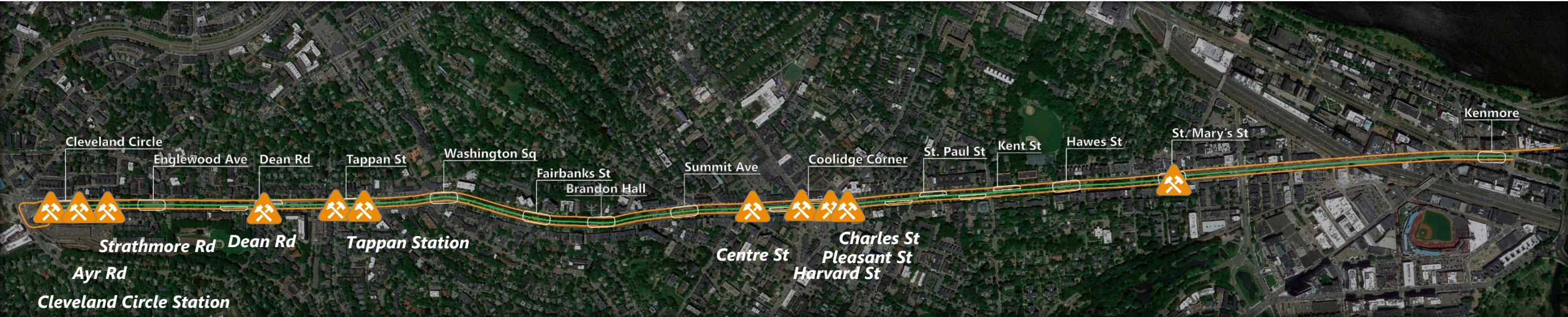

## Primary Scope of Work:

- **Full Depth Track Reconstruction** includes replacement of ballast, ties, rail, and drainage
- **Rubber Panel Crossing Reconstruction** at 11 locations (St. Marys, Charles, Pleasant, Harvard, Centre, Dean, Strathmore, Ayr, Cleveland Circle Station, Tappan Station - 2 locations)



**Rehabilitate more than two miles of track**



**Upgrade 7 Intersections**   
(and 4 isolated Pedestrian Crossings)

## Work also includes:

- Miscellaneous repairs and improvements to the power infrastructure
- Upgrade system maps, walkways, station brightening and edging at stations

# Track & Intersection Upgrades | *Trackwork Areas and Schedule*



#	Location	Period*
1	<b>St. Marys St to Portal</b>	Sunday, July 5 – Wednesday, July 8
2	<b>Coolidge Corner East and West</b>	Monday, July 6 – Monday, July 13
3	<b>Tappan Street</b>	Monday, July 13 – Friday, July 17 & Monday, July 20
4	<b>Dean Road</b>	Friday, July 17 – Monday, July 20
5	<b>Cleveland Circle to Englewood Ave</b>	Wednesday, July 15 – Monday, July 27
6	<b>Coolidge Corner - Harvard St</b>	Friday, July 24 – Monday, July 27
7	<b>Throughout - Surface, Align, Inspect, Test</b>	Tuesday, July 28 – Wednesday, August 1

*\*The schedule for this infrastructure project is weather dependent and subject to change without notice*

# Track & Intersection Upgrades | *Benefits for Riders*



## ***Mitigate risk of service interruptions***

by replacing track that is beyond its planned design life (73% of C Branch track 30+ years old)



## ***Improve travel times by 30 seconds in both directions (eastbound/westbound)***

and reduce future speed restrictions from latent track defects



## ***Install rubber panel for a smoother experience***

for passengers, bicyclists, and drivers over intersection crossings



## ***Improve pedestrian access and safety***

compliance with Americans with Disabilities Act (ADA) at 8 locations



---

## Making Connections During Construction





# Our Customers | Making Connections during Construction

## 1 Shuttle Buses

- ✓ Combination of traditional coach buses, and low-floor MBTA-style buses **on weekdays**
- ✓ MBTA buses **on weekends**

## 2 Shuttle Bus Stop Locations

- ✓ Accessible locations
- ✓ Consolidating stops to bypass 2 Green Line Stations: **Brandon Hall** and **Kent St**

## 3 Wayfinding & Alternatives

- ✓ Additional **Bluebikes** stations
- ✓ **Signage** to guide riders and pedestrians to shuttles
- ✓ Accessible pedestrian paths at work zones
- ✓ Identify alternate routes

## 4 Lane Configuration

- ✓ Dedicated **bus lanes** where possible
- ✓ Maintain existing **bike lanes**
- ✓ Advance warning signs
- ✓ Officers at key locations

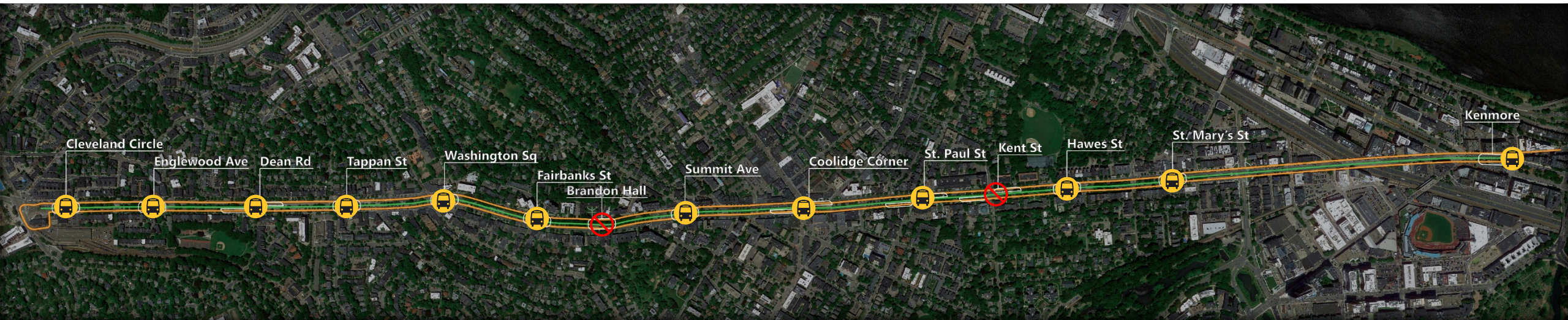

# Green Line C Branch Shuttle Bus Information

1

**Free, accessible shuttle buses** will operate between Kenmore and Cleveland Circle Stations

**Shuttle schedule** will meet or exceed frequency of current C Branch schedule

**Weekday and weeknight shuttle service:**

- Private carriers will operate a mixed fleet of **10 MBTA-style buses** and traditional coach buses

**Weekend shuttle service:**

- **MBTA buses** will be used

*All drivers trained to assist riders and operate lifts*

**Weekday and Weeknights Service**

**MBTA-Style Shuttles and Coach Buses**



**Weekend Service**

**MBTA Buses**



***For the health and safety of our riders, shuttle service will be monitored throughout the 28-days and adjusted to reduce crowding***

# Shuttle Stops Consolidated at Two Locations

We will consolidate shuttle stops at **Brandon Hall** and **Kent Street** in each direction

**Shuttle stops at all but two of the stations along the C Branch to optimize service and reduce travel times**

- Minimizing number of stops improves shuttle bus efficiency
- Diversions add less than 800 feet to a walking route
- Signage will advise customers where they can board shuttle buses

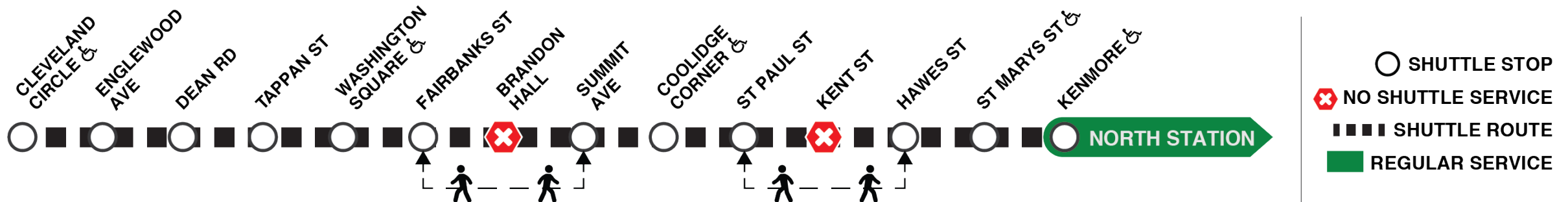

Riders will be **directed** to either **Fairbanks St** or **Summit Ave** instead of **Brandon Hall**



Riders will be **directed** to either **St. Paul St** or **Hawes St** instead of **Kent St**

# Bluebikes | Additional Temporary Stations and Bikes

Bluebikes to place temporary bike stations on Beacon St. to give riders additional options

Potential added locations during C Branch construction:

- Between Englewood Ave and Dean Rd
- Between Brandon Hall and Fairbanks St
- Between St. Paul St and Kent St
- Between Hawes St and St. Marys

Thank you Bluebikes for working with the MBTA  
Visit **Bluebikes.com** to learn more

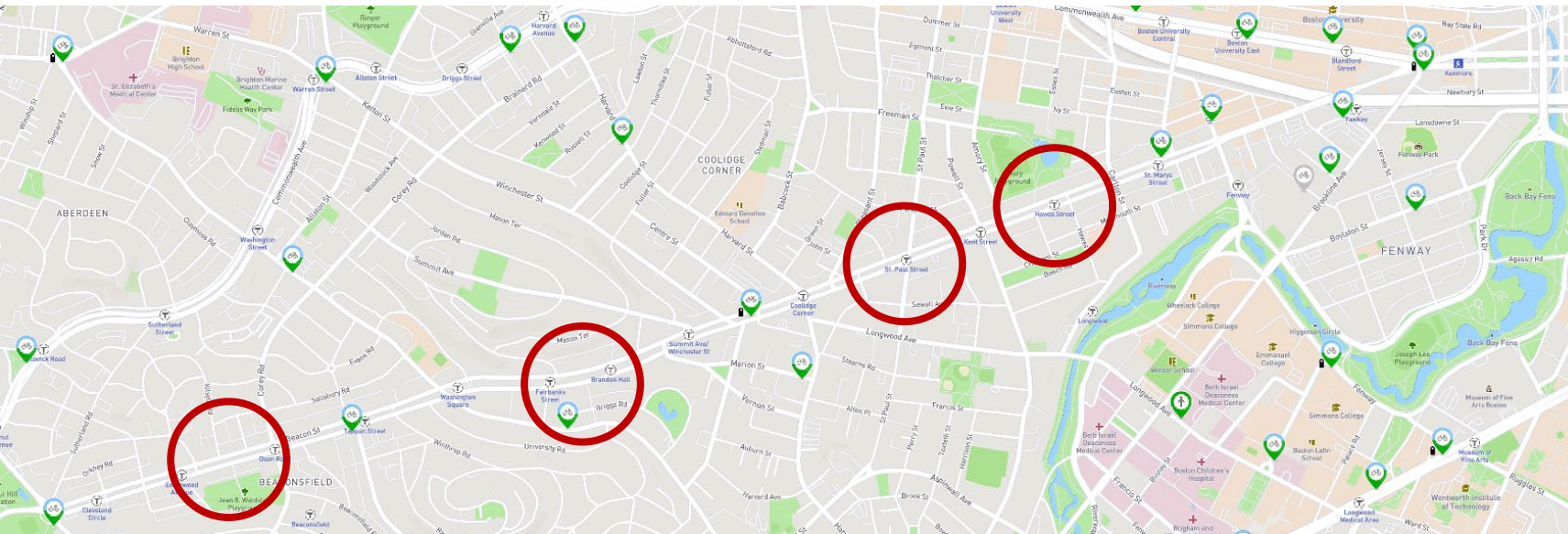

# Lane Configurations

Bus lane and combined bus/bike lane configurations along shuttle route for segments of Beacon St.

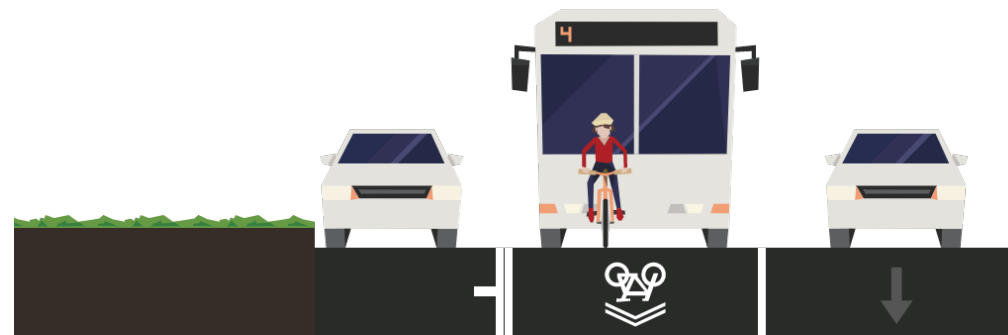
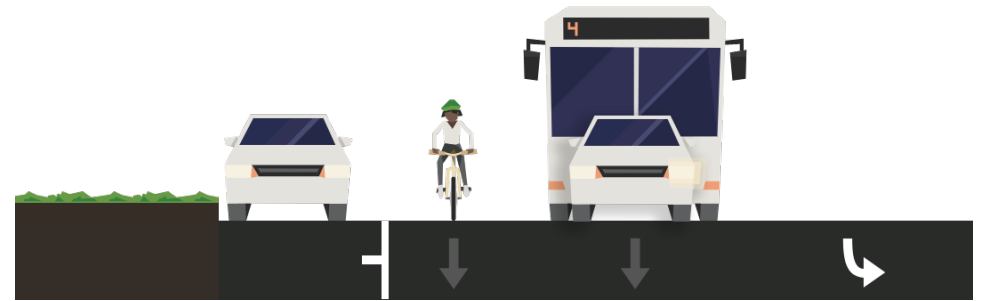
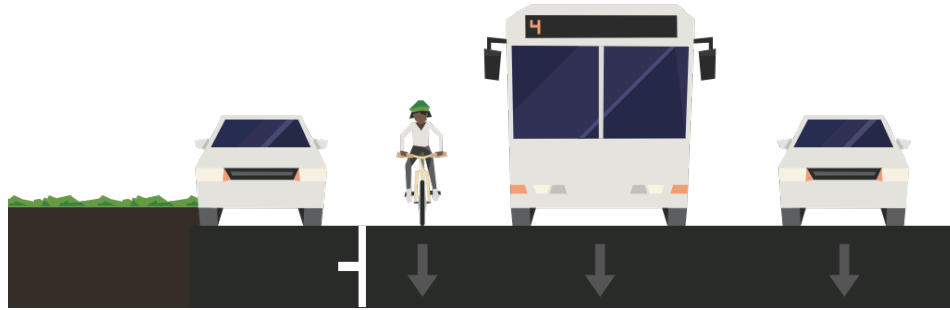

# Temporary Lane Closure | Coolidge Corner

## Beacon St. Westbound (WB) Lane Configuration

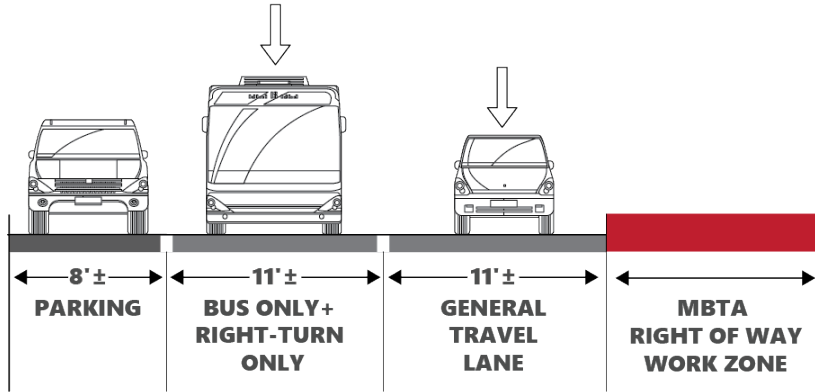

*Peak PM (2:00 PM – 7:00 PM)*

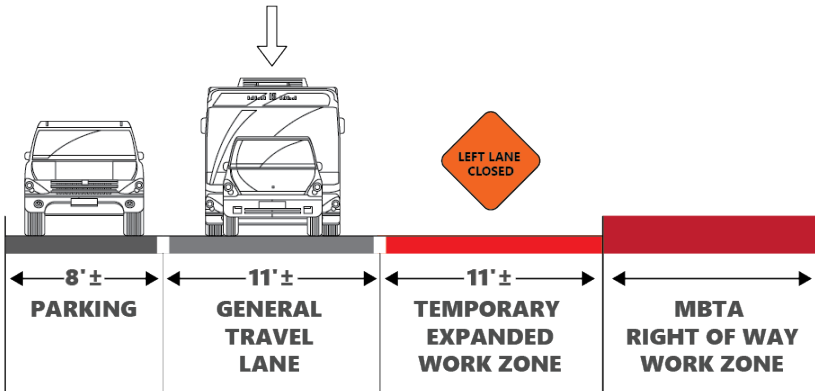

*Non-peak PM (outside the hours of 2:00 PM – 7:00 PM)*

## Beacon St. Eastbound (EB) Lane Configuration

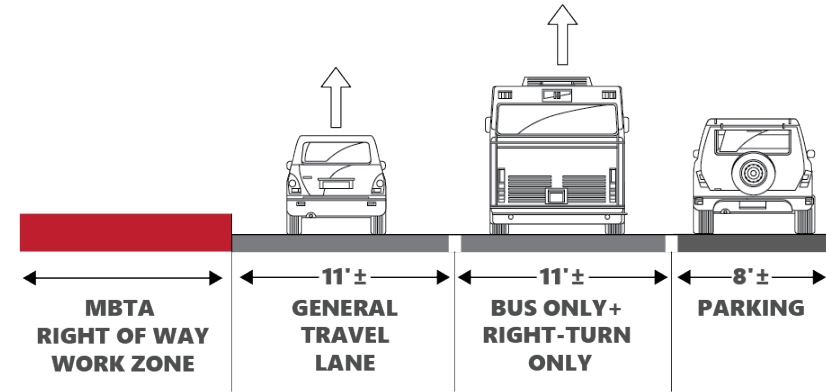

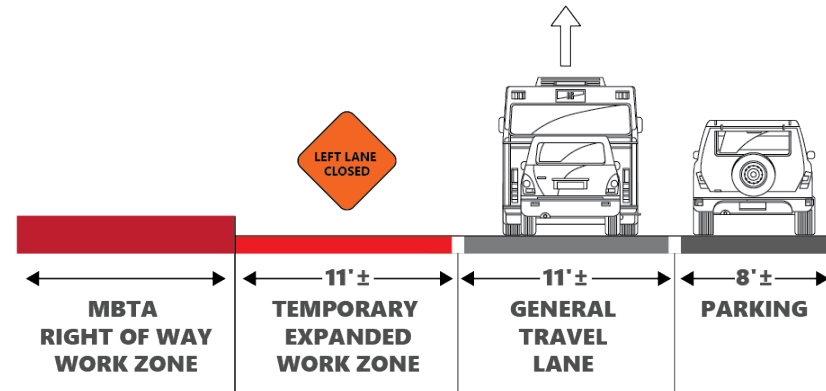

*Peak AM (6:00 AM – 10:00 AM)*



*Non-peak AM (outside the hours of 6:00 AM – 10:00 AM)*

# Advanced Messaging | Traffic Patterns

		
<b>Prior to Construction</b>	GRN LINE WORK AT BEACN ST	BEACN ST TRAFFIC CHANGE
	BEGINS DAY DATE	BEGINS DAY DATE
<b>During Construction</b>	GRN LINE WORK AT BEACN ST	BEACN ST BUS/BIKE RIGHT LANE
	SEEK ALT ROUTE	ALL OTHER TRAFFIC LEFT LANE

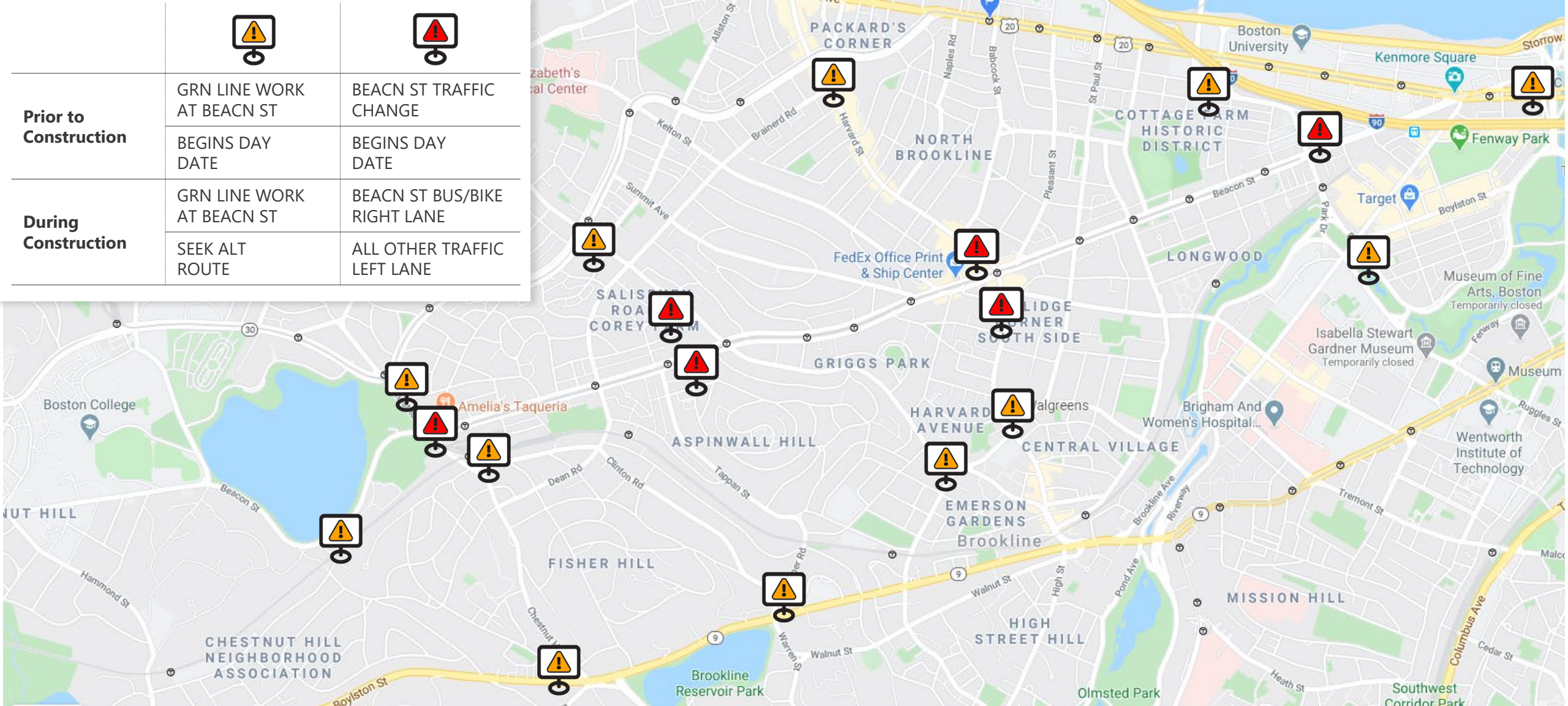



---

## Construction Sequence





# 28 Day Timeline | Sequence of Work

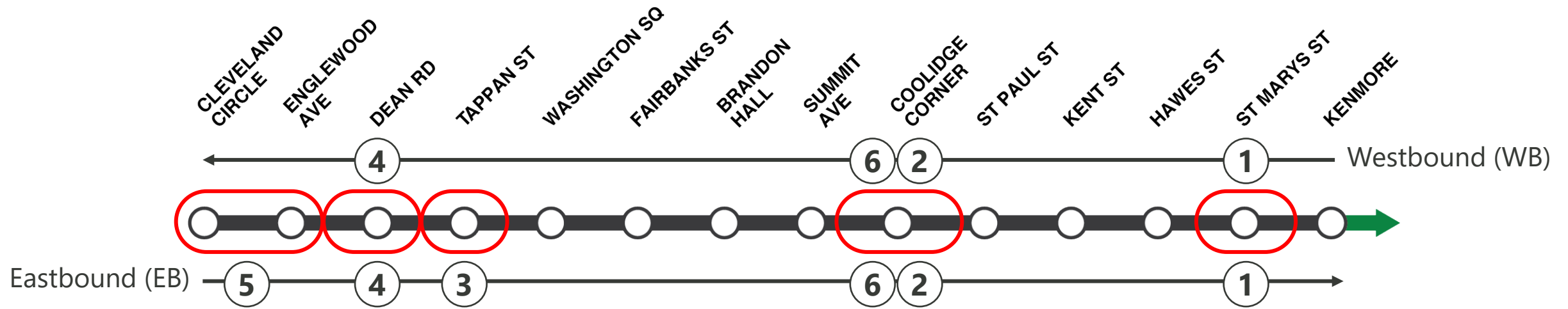

#	Work Location*	7/5	7/6	7/7	7/8	7/9	7/10	7/11	7/12	7/13	7/14	7/15	7/16	7/17	7/18	7/19	7/20	7/21	7/22	7/23	7/24	7/25	7/26	7/27	7/28	7/29	7/30	7/31	8/1	
		S	M	T	W	T	F	S	S	M	T	W	T	F	S	S	M	T	W	T	F	S	S	M	T	W	T	F	S	
1	St. Marys Street to Portal	█	█	█	█																									
2	Coolidge Corner East and West		█	█	█	█	█	█	█	█																				
3	Tappan Street Station									█	█	█	█	█			█													
4	Dean Road Intersection												█	█	█	█														
5	Cleveland Circle to Englewood Ave.											█	█	█	█	█	█	█	█	█	█	█	█	█	█	█	█	█	█	
6	Coolidge Corner - Harvard St.																				█	█	█	█						
	Surfacing, Aligning, Inspection, Testing																									█	█	█	█	█

\*The schedule for this infrastructure project is weather dependent and subject to change without notice

**St. Marys Station to Portal | *Sunday, July 5 – Wednesday, July 8***



# Coolidge Corner East & West | Monday, July 6 – Monday, July 13

## Non-Peak: Left Lane Closure Westbound & Left Lane Closure Eastbound

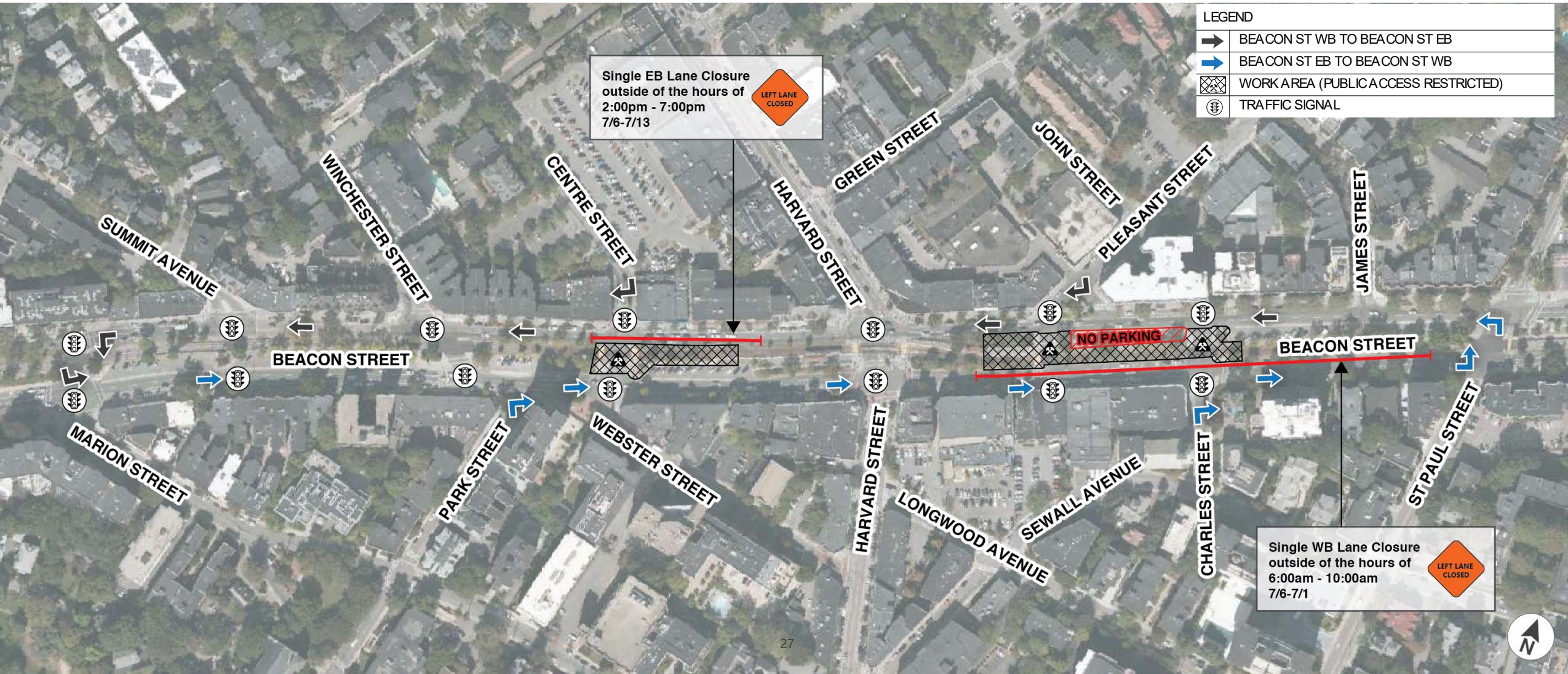

# Dean Road/Tappan Station | Monday, July 13 – Friday, July 17 - Monday, July 20

## Dean Road Weekend Closure & Left Lane Westbound; Tappan Station 5-Day Left Lane Closure Eastbound



# Cleveland Circle to Englewood | Wednesday, July 15 – Monday, July 27

Non-Peak: Left Lane Closure Ayr Road to Englewood Ave.

LEGEND	
	BEACON ST WB TO BEACON ST EB
	BEACON ST EB TO BEACON ST WB
	WORK AREA (PUBLIC ACCESS RESTRICTED)
	TRAFFIC SIGNAL

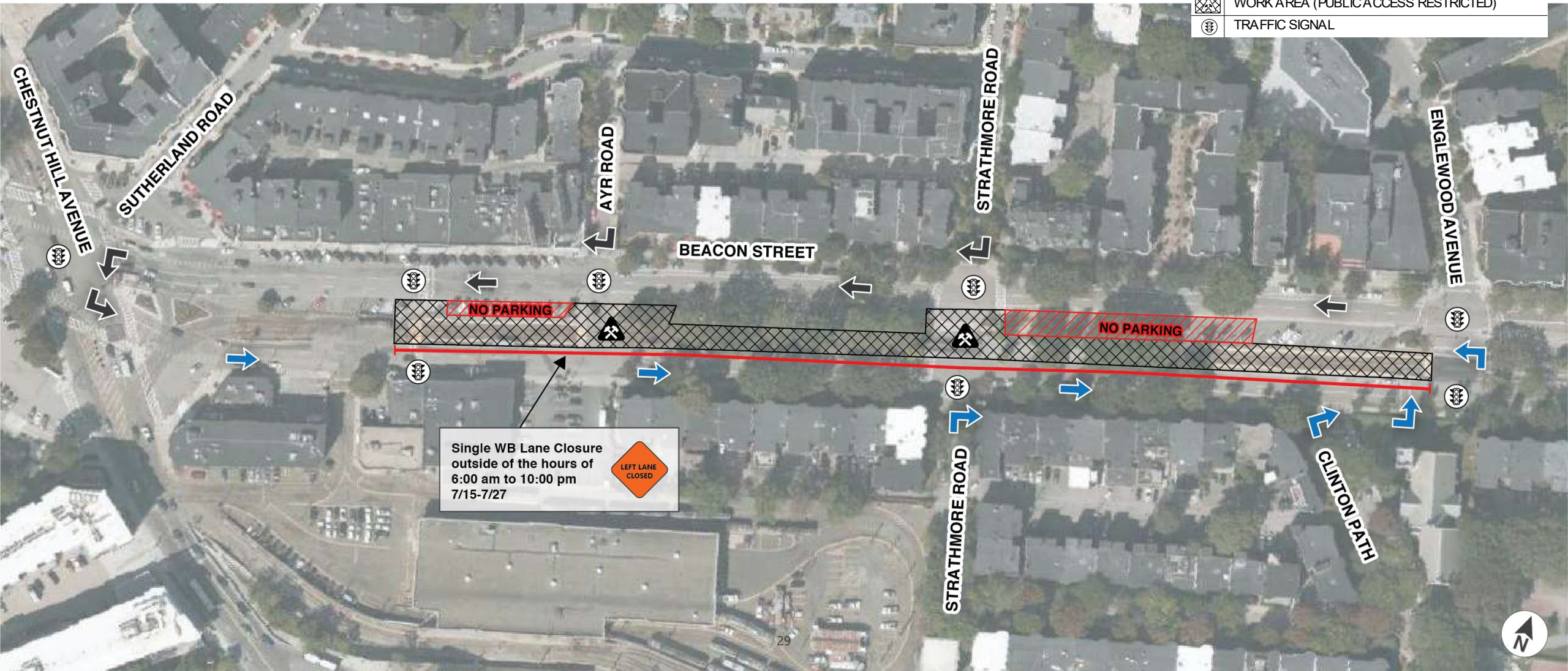

Single WB Lane Closure  
outside of the hours of  
6:00 am to 10:00 pm  
7/15-7/27



# Coolidge Corner – Harvard St | Friday, July 24 – Monday, July 27

## 5 Day Left Lane Closure (Westbound & Eastbound)

LEGEND	
	BEACON ST WB TO BEACON ST EB
	BEACON ST EB TO BEACON ST WB
	MBTA BUS ROUTE 66 DETOUR
	WORK AREA (PUBLIC ACCESS RESTRICTED)
	TRAFFIC SIGNAL

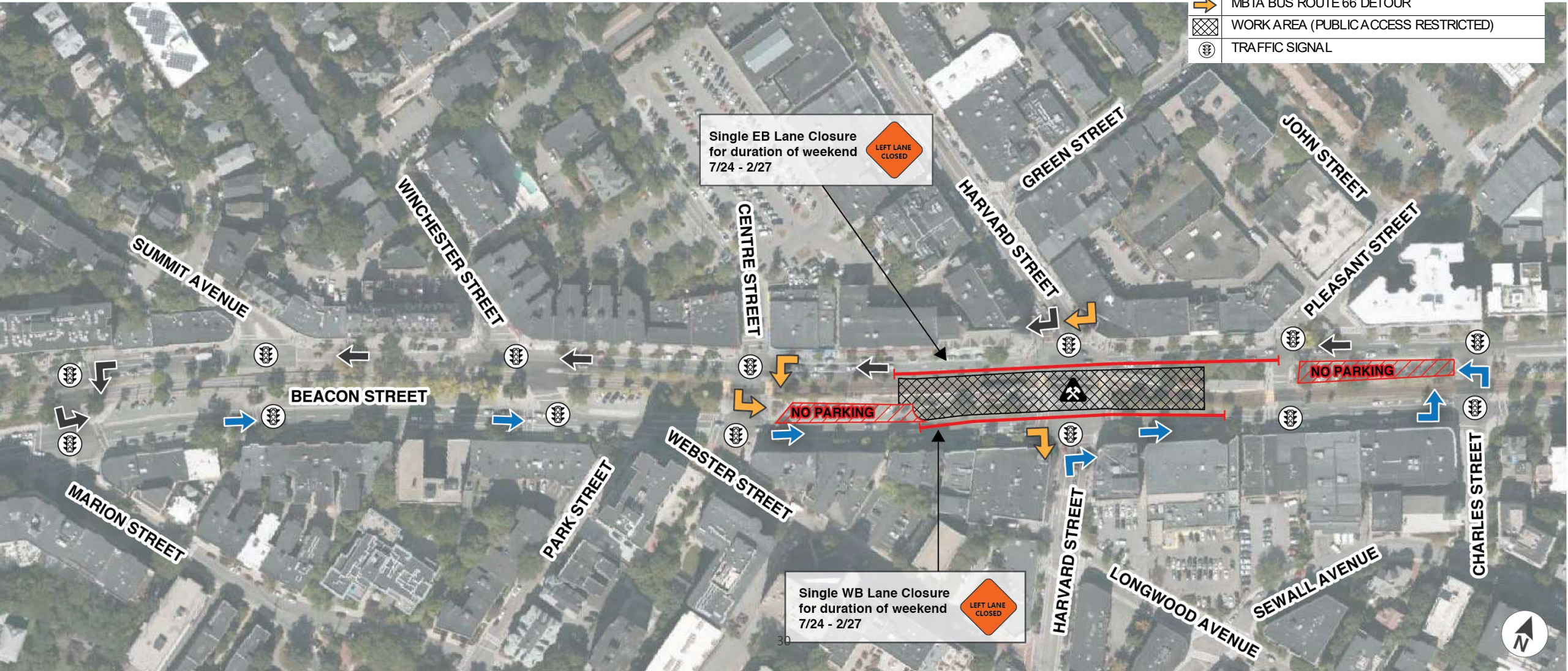

# Stay Connected



## Ask Questions and Be Informed

- ✓ Contact [GLT@mbta.com](mailto:GLT@mbta.com)
- ✓ Call 24/7 noise hotline: 508-676-3517
- ✓ Follow on social media
- ✓ **Subscribe to alerts** [mbta.com/alerts](http://mbta.com/alerts)
- ✓ Check website for up to date info
- ✓ Ask a Customer Service Agent



## Alternate Routes and Transit Options

- ✓ Regular service replaced by **shuttle buses**
- ✓ **Accessible pedestrian pathways well-marked** during closure
- ✓ Advanced messaging **signage for drivers**
- ✓ Expanded **Bluebike** locations
- ✓ **Plan ahead:** [mbta.com/glcwork](http://mbta.com/glcwork)

Contact us at: [GLT@mbta.com](mailto:GLT@mbta.com)  
[www.mbta.com/GLT](http://www.mbta.com/GLT)

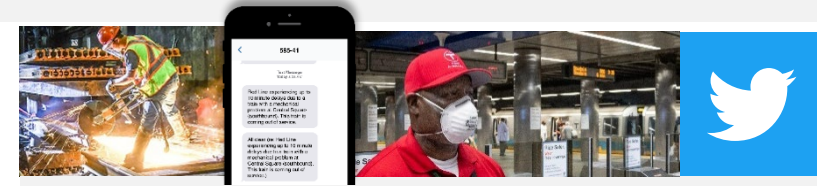

## Online & Social Media

Service Alerts  
Project Updates

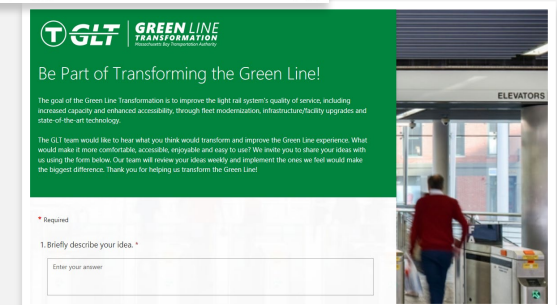
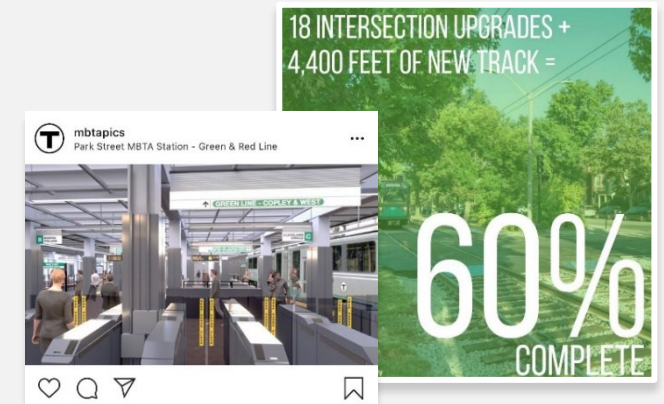

**Thank You!**



## Public Comment | *Next Steps*

Please share only one question or comment at a time

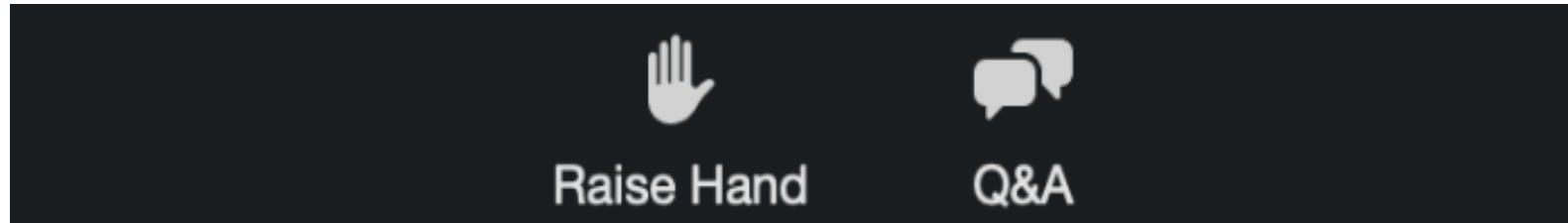

- Use the “**Q&A**” button to submit a typed question or comment
- Press the “**Raise Hand**” button to share your question or comment verbally. Wait for the moderator to recognize and unmute you before speaking.
- If you have joined by phone only, you may “raise your hand” by pressing the star button and then nine (\*9)

*After you speak, we will lower your hand and you will be muted to allow the team to respond and provide opportunities for others to participate*

**Comments may also be sent to [GLT@mbta.com](mailto:GLT@mbta.com)**