



Newton Highlands Green Line Station Accessibility Project



PUBLIC INFORMATIONAL MEETING

November 15, 2018

Project Goals and Objectives

The Massachusetts Bay Transportation Authority (MBTA) will improve accessibility at the Newton Highlands Station that will provide access for all customers and will be in compliance with current State and Federal regulations.



Project Location

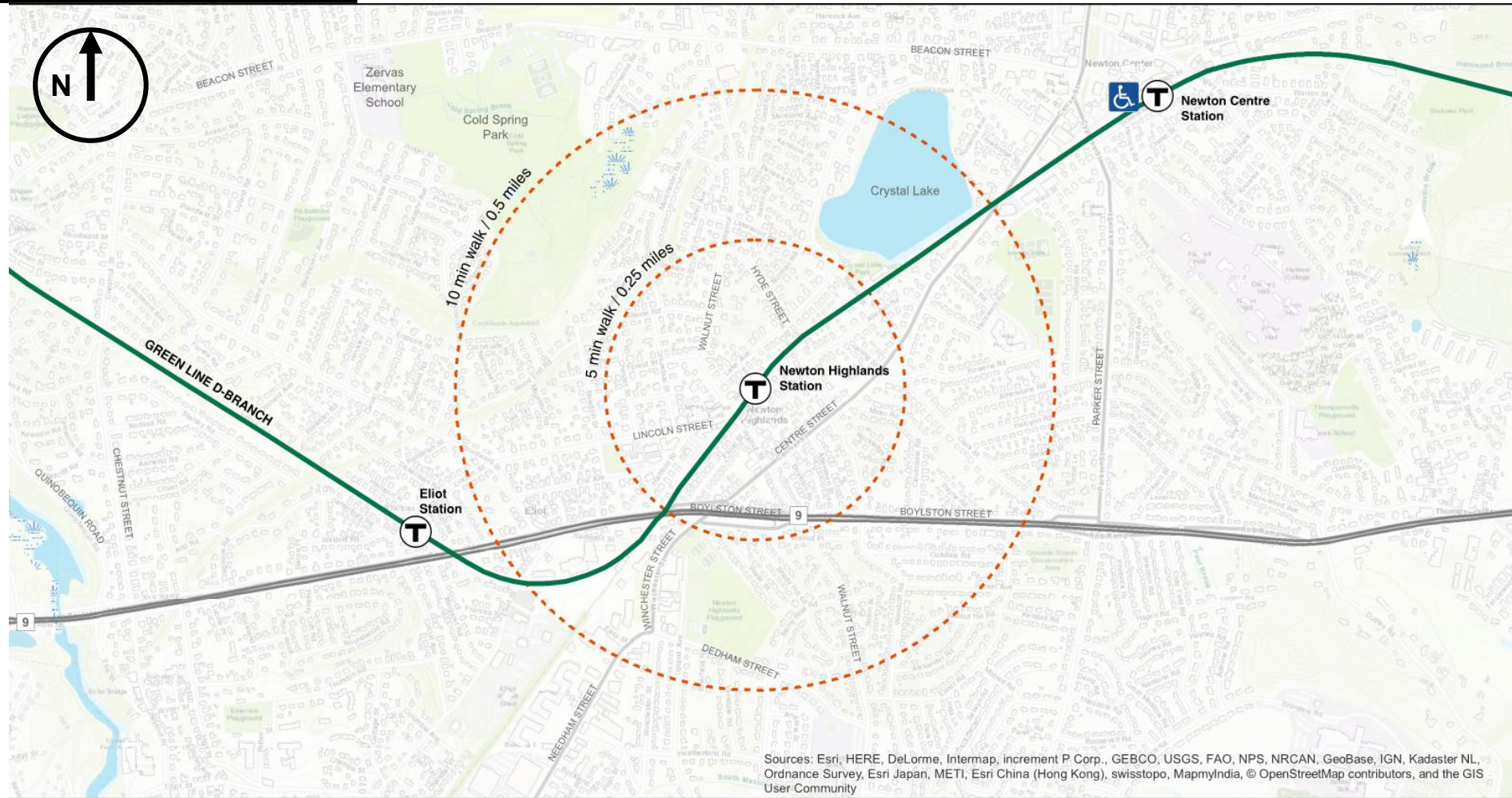

Data Source: MassGIS
Nitsch Project #9804.6

Sources: Esri, HERE, DeLorme, Intermap, increment P Corp., GEBCO, USGS, FAO, NPS, NRCAN, GeoBase, IGN, Kadaster NL, Ordnance Survey, Esri Japan, METI, Esri China (Hong Kong), swisstopo, MapmyIndia, © OpenStreetMap contributors, and the GIS User Community

Newton Highlands Green Line Station Accessibility Project



Proposed Station Improvements

- **Install and maintain temporary accessible ramp from Walnut Street until permanent ramps are built at other locations.**
- **New MAAB/ADA compliant ramps from Walnut Street, Station Avenue, and Hyde Street with canopies.**
- **Raised platforms with detectable warning strip designed to accommodate Type 10 vehicles.**
- **New aluminum shelters on Inbound Platform.**
- **New station amenities, such as benches, trash receptacles.**
- **New bicycle rack with canopy on Walnut Street.**
- **New station lighting.**
- **Two new 10-foot wide “At-Grade” Track Crossings.**
- **New Wayfinding Signage**
- **New Automatic Fare Collection Equipment**



Station Improvements - Proposed

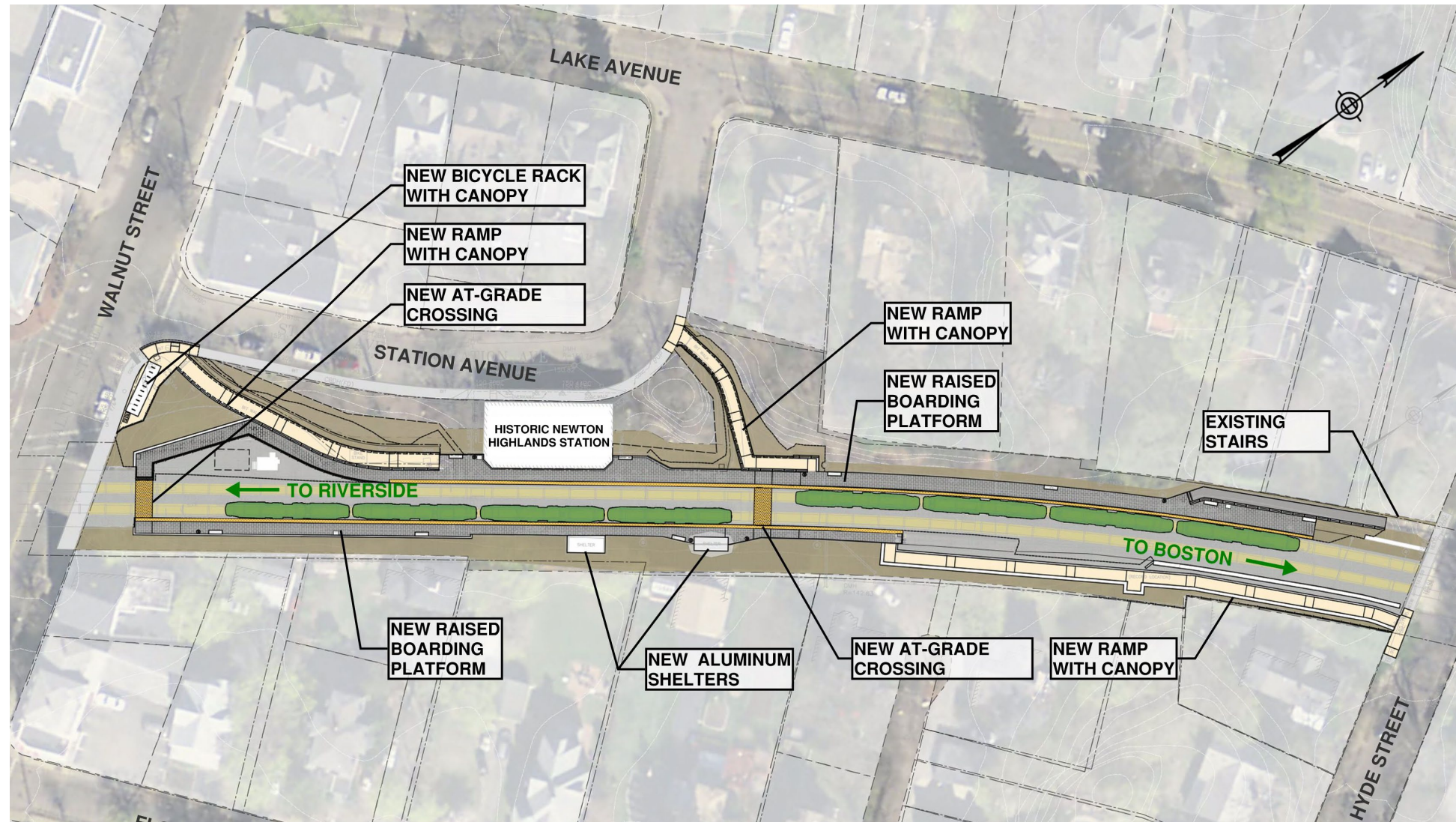

Newton Highlands Green Line Station Accessibility Project



Looking
North -
Existing



Newton Highlands Green Line Station Accessibility Project



Looking South - Existing



Newton Highlands Green Line Station Accessibility Project



Looking
from Walnut
Street -
Existing



Newton Highlands Green Line Station Accessibility Project



Looking from Walnut Street - Proposed



Newton Highlands Green Line Station Accessibility Project



Looking
towards
Walnut Street
- Existing



Newton Highlands Green Line Station Accessibility Project



Temporary Walnut Street Ramp

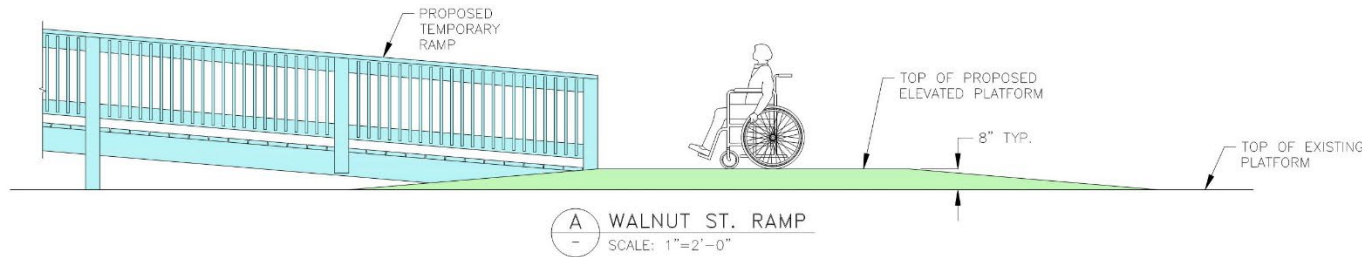
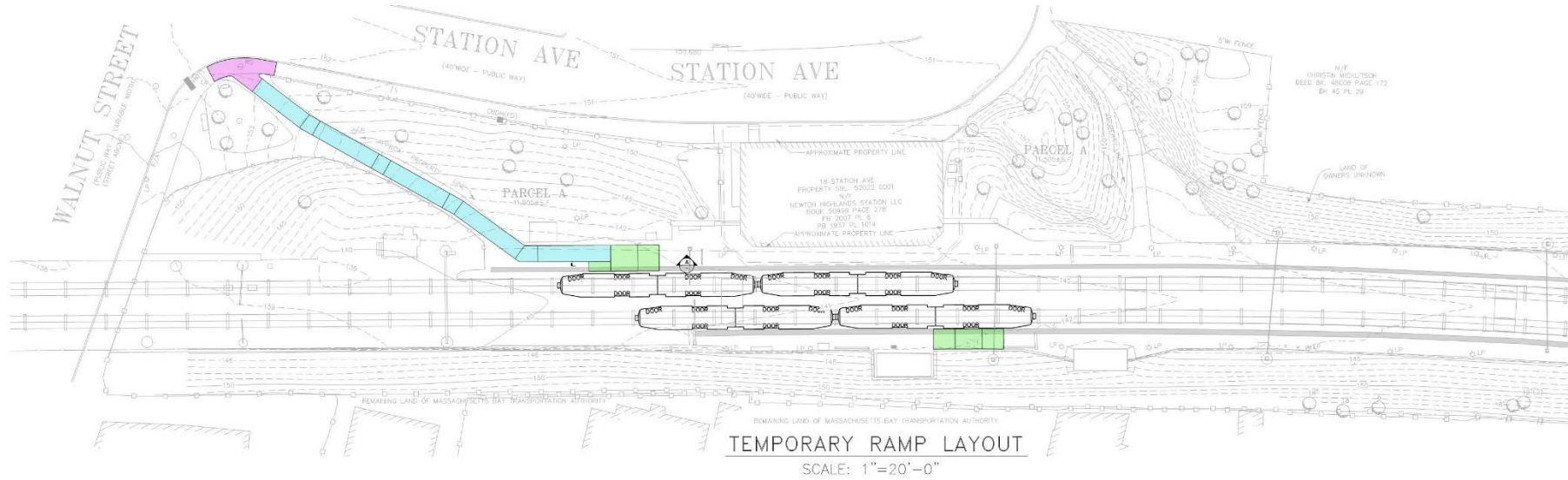

LEGEND:

- TEMPORARY RAMP
- ELEVATED PLATFORM
- ASPHALT LANDING/SIDEWALK

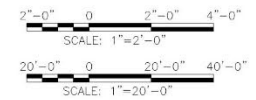

Looking towards Walnut Street - Proposed



Newton Highlands Green Line Station Accessibility Project



Looking
towards
Hyde Street -
Existing



Newton Highlands Green Line Station Accessibility Project



Looking
towards Hyde
Street -
Proposed



Newton Highlands Green Line Station Accessibility Project



**Looking from
Station Avenue -
Existing**



Newton Highlands Green Line Station Accessibility Project



Looking from Station Avenue - Proposed



Newton Highlands Green Line Station Accessibility Project



Looking from
Hyde Street -
Existing



Newton Highlands Green Line Station Accessibility Project



Looking from Hyde Street - Proposed



Newton Highlands Green Line Station Accessibility Project



Project Schedule and Cost

- **Current Design Stage: 75%**
- **Final Design Completion - Spring 2019**
- **Timing of Construction - Option to construct concurrently with the Riverside Track and Signal Project or wait until the completion of the Riverside Track and Signal Project.**
- **Scheduling construction of Newton Highlands Station after the completion of the Riverside Track and Signal Project may reduce the construction duration and cost.**
- **Project Construction Estimate \$ 16.9 Million**
- **Additional Funding will be required.**



QUESTIONS / COMMENTS

<https://www.mbta.com/projects/newton-highlands-station-accessibility-improvements>

Thomas Rovero Project Manager – MBTA
trovero@mbta.com

Newton Highlands Green Line Station Accessibility Project

